

METRO**FIRE**

10 ALARM RUN CARDS



2024

Rev. 1.02

PUBLIC RELEASE VERSION

Updates To Plan

Issued

February 5, 2024

Table of Contents

SECTION 1

Running Card User Guide	5
Metrofire Summary Status and Activity Reporting PROC 10-1	6
Community Run cards (alphabetical order)	7
INFO Blank Update Card	81
INFO Special Apparatus	83
INFO Specialized Units	84
INFO Metrofire District Map	85
INFO Mutual Aid Signals	86
INFO Standard Community Abbreviations	87
INFO Radio Channel Assignments Designate By Community	88
INFO Massport Logan Staging Area Maps	89
INFO MBHSR Technical Response Definitions	95
INFO MBHSR Technical Response North Response	96
INFO MBHSR Technical Response South Response	97
INFO MBHSR Hazmat or Weapons of Mass Destruction Response	98

This page left intentionally Blank

METROFIRE-Running Card User Guide

The following information is supplied as a guide to the use of the Metrofire 10-Alarm Running Cards.

The heavy line separating the alarm level blocks indicate the level at which the Metrofire Control Center takes over the dispatching function.

() Units noted in parenthesis denote units that are responding to the fire scene from a previous cover assignment. At local option, some communities have elected to have covering apparatus remain in their assigned stations and, on subsequent alarms, apparatus responding from other communities report directly to the fire.

*** or **** Asterisks denote communities outside of the Metrofire district. Notations at the bottom of the card indicate the method required to contact them. The Control Center will generally make contact through the statewide network.

@@ Is a response that will be assigned by the local Fire Alarm/Dispatch Office

Notation of unit numbers listed with a community on cover assignments denote the unit or station to be covered in the requesting community.

The Additional Apparatus; Engines and Ladders block at the bottom of the form indicate additional units that may be assigned beyond the 10th Alarm level, while still maintaining the required district protection.

The Statewide Fire Mobilization Plan (SFMP)- If Metrofire resources are exhausted an IC can implement the SFMP and is governed by the specific Fire District the community is a member of and not a mutual aid organization. The District 13 Run Cards can be found at mass.gov/mema. If another Fire District implements the SFMP and District 13 is to respond the specific inventory for the specific Task Force requested can be found at mass.gov/mema. District 13 (the majority of Metrofire) is broken up into multiple Task Forces. Response to a SFMP is governed by the SFMP plan and not Metrofire.

Responsibility for dispatch of lower alarm levels, as designated on the running cards by the heavy line separating the alarm level blocks, remain with the local community. Where standard assignments exist, they have been listed. Due to the varying assignments within individual communities, many lower level assignment blocks have intentionally been left blank. It is imperative that utilization of mutual aid resources at the lower alarm levels be reported to the Control Center.

A form for requesting changes to a communities running card is included at the end of the running card set. All changes must be approved by Metrofire and published prior to taking effect.

METROFIRE-Summary Status and Activity Reporting

Metrofire Control operates on the UHF frequency of 483.2875 MHz (White Channel) and all community dispatch centers in the district will communicate with the control center and each other on this frequency. **No portable or mobile radios** will operate on this frequency.

The Metrofire Mutual Aid System is only as effective as the communications between communities and with the Control Center. Listed below is a summary of actions and protocols required to be utilized by local community dispatchers.

- The Control Center must be notified each time your department's apparatus responds to or returns from a mutual aid assignment. Line boxes do not require notification unless a company is working a fire at the location.
- The Control Center must be notified each time a working fire exists or a multiple alarm is transmitted in your community. Provide the Alarm Level, Location of the incident, type of incident, Fireground and covering channel assignment, as well as any information or direction from the IC.
- Report availability of mutual aid resources **ONLY** during the daily radio test. If availability of resources has changed for any reason, when requested by the Control Center to respond to another community, simply state, "Unable to respond" and the Control Center will request the first due units from the next alarm level to respond.
- Request coverage for unfilled routine assignments or unusual activity levels. Coverage may be obtained from specific communities if requested. If no community is specified, the Control Center will request the first due units from the next alarm level to respond.
- Request greater alarm levels in addition to the normal assignments by requesting the specific level required. Provide the Alarm Level, Location, and Channel Assignment. Additional information such as Staging Location, Specified Routes, etc. may be necessary.
- Request specialized apparatus or equipment, giving details of need and location of the incident. This includes the HazMat Units, Air Supply Unit, Communications Unit, Rehabilitation Unit, State Police, MBTA, CISD Team, and other specialized units.

Announcements of multiple alarms, activation of special teams, evacuation signals and status reports on incidents will be broadcast on White Channel 483.2875 MHz(Dispatch Channel).

Metrofire 10 Alarm Run Cards

Public Version

2024 Revision 1.02

By

Community

Effective

0800 Hours February 19, 2024

ARLINGTON

Emergency Phone:

Business Phone:

CENTRAL STATION (HEADQUARTERS)

411 Massachusetts Avenue (Broadway & Mass. Ave)

E1, L1, C2

HIGHLAND STATION

1007 Massachusetts Avenue opposite Walnut Street

E2, R1, L2

PARK CIRCLE STATION

291 Park Avenue (Near Route 2)

E3

METROFIRE RUNNING CARD

ARLINGTON

MUTUAL AID BOX 8229

FIREGROUND PRIMARY CHANNEL Arlington Fire Channel 1 460.600							ALT. FG Metro North FIREGROUND				
COVERING PRIMARY CHANNEL Metro North DISTRICT							ALT. COV NONE				
	TO FIRE						COVER				
ALARM	ENGINES			LADDERS	SPECIAL	CHIEFS	ENGINES			LADDER	
1ST							<u>E-2</u>		<u>Headquarters</u>		
WF							CAM			SOM	
2ND	(CAM) "RIT"			(SOM)						MED	
3RD	(WINC)			(MED)			WAL		WOB	CAM	
4TH	(WOB)	(WAL)	MAL	(CAM)			WAT		CAM	WAL	
5TH	(CAM)	(WAT)	BOS	(WAL)		BOS	STON		BUR	MAL	
6TH	(BUR)	(STON)	EVE	(MAL)			BOS		MEL	BOS	
7TH	(MEL)	(BOS)	REA	(BOS)			NEW		WAL	NEW	
8TH	(WAL)	(NEW)	REV	(NEW)			BOS		BRK	BRK	
9TH	(BRK)	(BOS)	WAK	(BRK)			CHE		WEL	DED	
10TH	(WEL)	(CHE)	WEST	(DED)			SAU		NEE	EVE	
ADDITIONAL ENGINES:		BOS, DED			LADDERS:			BOS, LYN		Rev Date	Issue Date
() Responding from Coverage Assignment All Blank Companies above Heavy Line are per Local Runcards									2/1/2022	2024-1	

BELMONT

Emergency Phone

Business Phone

HEADQUARTERS
299 Trapelo Road

E1, R1, C3
DFS Hazmat TOMS 21

STATION 2
99 Leonard Street

E2, L1

METROFIRE RUNNING CARD

BELMONT

MUTUAL AID BOX 8231

FIREGROUND PRIMARY CHANNEL Belmont Fire Ch. 1 482.7750					ALT. FG Belmont Fire Ch 3 453.2375						
COVERING PRIMARY CHANNEL Belmont Fire Ch. 3 453.2375					ALT. COV Metro North District						
	TO FIRE					TO COVER					
ALARM	ENGINES			LADDERS	SPECIAL	CHIEFS	ENGINES			LADDER	
1ST							HQ E-1		STATION 2 E2 L1		
WF	CAM "RIT"										
2ND											
3RD									WINC	SOM	
4TH	(WINC)	(COV @ E1)	SOM	(SOM)			NEW		MED	NEW	
5TH	(NEW)	(MED)	BRK	(NEW)			WEST		WOB	MED	
6TH	(WEST)	(WOB)	BUR	(MED)			BOS		MAL	BRK	
7TH	(BOS)	(MAL)	EVE	(BRK)		BOS	BOS		MEL	MAL	
8TH	(BOS)	(MEL)	CHE	(MAL)			BOS		REA	EVE	
9TH	(BOS)	(REA)	WEL	(EVE)			WAK		DED	BOS	
10TH	(WAK)	(DED)	SAU	(BOS)			BOS		QUI	BOS	
ADDITIONAL ENGINES:		MIL, RAN, QUI, WEY			LADDERS:		BOS			Rev Date	Issue Date
() Responding from Coverage All Blank Companies above Heavy Line are per Local Runcards										2/1/2024	2024-1

Boston Fire Alarm Operations, 59 Fenway

Fire Headquarters, 115 Southhampton Street.

DIVISION 1 125 Purchase St Downtown

District 1 360 Saratoga St. East Boston Dist. 1, E5
239 Summer St. East Boston E9, L2,
H5 Decontamination Supply Unit
1 Ashley St East Boston E56, L21

District 3 200 Cambridge St West End Dist. 3, E4, L24
392 Hanover St. North End E8, L1
525 Main St. Charlestown E32, L9
34 Winthrop St. Charlestown E50
50 Battery Wharf North End Marine Units

District 4 200 Columbus Ave Back Bay E7, TL17
618 Harrison Ave South End E3, H2 (Lighting Plant)
700 Tremont Street E22, W25 EMS Service,
H3 Hazmat Supply Unit
941 Boylston St Back Bay E33, L15
59 Fenway TACCOM, Fieldcomm

District 6 272 D St. South Boston E39, L18, H7 Mobile Decon
700 East Fourth St South Boston E2, L19
125 Purchase St. Downtown E10, TL3, RES 1
H4 Tech Rescue Support 1, H6 Collapse

District 11 138 Chestnut Hill Ave Brighton Dist 11, E29, L11
460 Cambridge Street Allston E41, L14
425 Faneuil St. Brighton E51

DIVISION 2 746 Centre St. Jamaica Plain

District 7 7 Parish St. Dorchester E17, L7
641 Columbia Rd E21
36 Washington St. Dorchester E24, L23
174 Dudley St. Roxbury E14, L4, H1 Safety Chief

District 8 9 Gallivan Blvd. Dorchester Dist. 8, E16
1884 Dorchester Av Dorchester E18, L6
301 Neponset Av. Dorchester E20
Fire Academy Moon Island

District 9 1870 Columbus Av. Roxbury Dist. 9, E42, RES 2
746 Centre St. Jamaica Plain E28, TL10,
H8 Tech Rescue Support 2
560 Huntington Av. Roxbury E37, L26

District 10 5115 Washington St. W. Roxbury E55, Brush 55
1940 Centre St. W. Roxbury E30, L25
209 Neponset Valley Pkwy Readville E49

District 12 945 Canterbury St. Roslindale Dist. 12, E53, L16
60 Fairmount Av. Hyde Park E48, L28, Brush 48
975 Blue Hill Av. Dorchester E52, L29

METROFIRE RUNNING CARD

BOSTON

MUTUAL AID BOX 8212

FIREGROUND PRIMARY CHANNEL As Assigned by Boston Fire Alarm						ALT. FG As Assigned by Boston Fire Alarm			
COVERING PRIMARY CHANNEL Boston Fire Ch. 1 483.1625									
	TO FIRE					COVER			
ALARM	ENGINES		LADDERS	SPECIAL	CHIEFS	ENGINES		LADDERS	
1ST									
WF									
2ND									
3RD									
4TH									
5TH									
6TH						BRK TO E-28	CAM TO E-33	QUI TO E-18	QUI TO E-20 BRK TO L-14
7TH						NEE TO E-30	NEW TO E-51	SOM TO E-32	
8TH						CHE TO E-9	DED TO E-48	WINT TO E-56	CAM TO L-15
9TH						EVE TO E-8	MIL TO E-16	WAT TO E-37	
10TH						MAL TO E-10	REV TO E-5	WAL TO E-41	
ADDITIONAL	ENGINES: BEL, WEL, BRA, MED			LADDERS: WAL, MED					
() Responding from Cover Assignment. All Blank Companies are per Local Runcards								Rev. Date	Issue Date
@ = Cover assignment will be assigned by Boston Fire Alarm								4/14/2022	2024-1

BRAINTREE

Emergency Phone

Business Phone

HEADQUARTERS

One Union Place Corner of Washington St.

E1, E4, L2

HIGHLANDS STATION

1625 Washington St.

E2, LT1, R2 (MBTA-Braintree Heavy Rescue)

EAST BRAINTREE STATION

One Hayward St @ Commercial St.

E3

METROFIRE RUNNING CARD

BRAINTREE

MUTUAL AID BOX 8244

FIREGROUND PRIMARY CHANNEL Braintree Fire Ch 1 483.5125						ALT FG Assigned by NFCC			
COVERING PRIMARY CHANNEL Assisgned by Norfolk County Control						ALT COV None			
	TO FIRE					TO COVER			
ALARM	ENGINES			LADDERS	SPECIAL	CHIEFS	ENGINES		LADDER
1ST							<u>E-2</u>	<u>E-3</u>	<u>E-1 & L-2</u>
WF									
2ND							HOL*	WEY	RAN QUI
3RD	(RAN)	(WEY)	(HOL)*	(QUI)			AVO*	QUI	QUI BOS
4TH	BOS	BRKTN*	STOT*	CAN*		BOS			
5TH	BOS	HIN**	ABI*	BRKTN*	DFS ISU				
6TH	DED	ROC*	NORWL**	BOS					
7TH	NEE	BRK*	WEST	NEW					
8TH	NEW	WEL	CHE	BKLE					
9TH	BOS	CAM	SOM	SOM					
10TH	BOS	WAL	REV	WAL					
ADDITIONAL ENGINES:		CAM, EVE, MED			LADDERS:		CAM, WAT		
() Responding from Coverage Assignment All Blank Companies above Heavy Line are per Local Runcards									
* ABI (ABINGTON), (AVO) AVON, BRKTN (BROCKTON), CAN (CANTON), HOL (HOLBROOK), ROC (ROCKLAND), STOT (STOUGHTON), CONTACT NORFOLK COUNTY CONTROL... **NORWL (NORWELL), HIN (HINGHAM) (CONTACT PLYMOUTH CONTROL)							Rev Date	Issue Date	
							2/1/2022	2024-1	

BROOKLINE

Emergency Phone

Business Phone

STATION 1 BROOKLINE VILLAGE

140 Washington St. @ High St.

E1, L2, C3 (Shift Commander)

STATION 4 ROUTE 9

827 Boylston St. @ Reservoir Rd.

E4, Squad 1, MDU Decon Trailer, Rescue Boat

STATION 5 COOLIDGE CORNER

49 Babcock St. near John St.

E5, L1

STATION 6 TRAINING DIVISION & MAINTENANCE DIVISION

962 Hammond St near Horace James Circle

E6

STATION 7 WASHINGTON SQUARE

665 Washington St. near Beacon St.

E3

METROFIRE RUNNING CARD

BROOKLINE

MUTUAL AID BOX 8222

FIREGROUND PRIMARY CHANNEL Brookline Fire Ch 1. 483.4375							ALT. FG Metro CENTRAL FIREGROUND			
COVERING PRIMARY CHANNEL Metro Central DISTRICT							ALT. COV.			
	TO FIRE						COVER			
ALARM	ENGINES			LADDERS	SPECIAL	CHIEFS	ENGINES			LADDER
1ST							<u>E-1</u>	<u>E-4</u>	<u>E-5</u>	<u>L-2</u>
WF							BOS			BOS
2ND	(BOS)			(BOS) CAM "RIT"	CAM SQUAD	BOS CAM	CAM	NEW	BOS	NEW
3RD	(CAM)	(BOS)	(NEW)	(NEW)		NEW	BOS	NEW	BOS	BOS
4TH	(BOS)	(NEW)	(BOS)	(BOS)			CAM	SOM	WAT	SOM
5TH	(CAM)	(SOM)	(WAT)	(SOM)			WEST	DED	WAL	WEL
6TH	(WEST)	(DED)	(WAL)	(WEL)			NEE	BEL	MED	WAL
7TH	(NEE)	(BEL)	(MED)	(WAL)			ARL	MAL	WAL	CHE
8TH	(ARL)	(MAL)	(WAL)	(CHE)			WINC	EVE	CHE	QUI
9TH	(WINC)	(EVE)	(CHE)	(QUI)			MIL	LEX	QUI	MAL
10TH	(MIL)	(LEX)	(QUI)	(MAL)			MEL	REV	RAN	EVE
ADDITIONAL	ENGINES: BUR				LADDERS: MED		Rev. Date	Issue Date		
() Responding from Coverage All Blank Companies above Heavy Line are per Local Runcards							3/1/2023	2024-1		

BURLINGTON

Emergency Phone

Business Phone

**HEADQUARTERS STATION
21 Center St.**

E1, E3, A1, C3

**SUBSTATION WEST BURLINGTON
114 Terrace Hall Ave**

E2, T1, A2

METROFIRE RUNNING CARD

BURLINGTON

MUTUAL AID BOX 8258

FIREGROUND PRIMARY CHANNEL Burlington Fire Ch. 1 483.3625						ALT. FG Metro North FIREGROUND@			
COVERING PRIMARY CHANNEL Metro Fire North DISTRICT						ALT. COV None			
	TO FIRE					COVER			
ALARM	ENGINES			LADDERS	SPECIAL	CHIEFS	ENGINES		LADDER
1ST									
WF									
2ND									
3RD									
4TH	WAL	TEW*	CON*	WAL		LEX			
5TH	WAK	NREA**	MED	LOW*		BIL*			
6TH	SOM	WEST	SAU	SOM					
7TH	MAL	MEL	BEL	MAL					
8TH	NEW	CAM	WAT	NEW					
9TH	BOS	REV	WEL	BOS		BOS			
10TH	LYN	EVE	BRK	LYN TOWER					
ADDITIONAL ENGINES: CAM, WAL, BOS, MED				LADDERS: CAM, BOS, MED					
All Blank Companies above Heavy Line are per Local Runcards									
*CON (CONCORD), LOW (LOWELL), TEW (TEWKSBURY), BIL (BILLERICA) CONTACT THRU WESTFORD CONTROL)							Rev Date	Issue Date	
**NREA (NORTH READING), CONTACT THRU BEVERLY CONTROL. @ assigned							2/1/2022	2024-1	

CAMBRIDGE

Emergency Phone

Business Phone

~~HEADQUARTERS HARVARD SQUARE~~

~~CLOSED FOR RENOVATIONS until 2027/28~~

~~491 Broadway @ Cambridge St.~~

~~E1, L1, R1, R2, HM1,~~

~~Dive Rescue~~

LAFAYETTE SQUARE STATION

378 Massachusetts Av. Opp. Columbia St.

E2, L3, SQ2

LECHMERE SQUARE STATION

173 Cambridge St. @ Second St.

E3 (foam), LT2, Tactical Rescue

PORTER SQUARE STATION

2029 Massachusetts Av. @ Blake St.

E4, SQ4

INMAN SQUARE STATION

1384 Cambridge St. @ Hampshire

E5, DIV 1

CAMBRIDGEPORT STATION

176 River St

E6 (foam)

TAYLOR SQUARE STATION

113 Garden St @ Sherman St.

E8, L4, DIV 2

STATION 9

67 Lexington Av. Near Huron Av.

STATION 10 (Temporary during HQ Renovations)

15 Hovey Av. (corner of Cambridge St.)

E1, L1, R1

Administrative Offices (Temporary during HQ Renovations)

32 Bay State Road

METROFIRE RUNNING CARD

CAMBRIDGE

MUTUAL AID BOX 8218

FIREGROUND PRIMARY CHANNEL Assigned by Cambridge Fire Alarm						ALT. FG As Assigned By Cambridge				
COVERING PRIMARY CHANNEL Cambridge Fire Ch. 1 471.3125						ALT. COVERING NONE				
	TO FIRE					COVER				
ALARM		ENGINES		LADDERS	SPECIAL	CHIEFS		ENGINES		LADDER
1ST										
WF										SOM TO L4
2ND							SOM TO E-3	ARL TO E-4	BEL TO E-8	BRK TO L3
3RD			SOM	(SOM)			WAT TO E-1	BRK TO E-2	BOS TO E-6	WAL TO L-1
4TH	(WAT)	(BEL)	(BRK)	(BRK)			WAL TO E-1	BOS TO E-2	NEW TO E-8	BOS TO L-3
5TH	(WAL)	(SOM) From E-3	(ARL)	(BOS)		BOS	CHE TO E-1	BOS TO E-3	MED TO E-4	NEW TO L-3
6TH	(CHE)	(MED)	(NEW)	(WAL)			MAL TO E-1	LEX TO E-4	WAL TO E-8	MED TO L-1
7TH	(MAL)	(LEX)	SAU	(MED)			MSPRT TO E-1	STON TO E-4		MAL TO L-1
8TH	(MSPRT)	EVE	REV	(MAL)			WINC TO E-1			CHE TO L-1
9TH	(WINC)	LYN	MEL	(CHE)			WAK TO E-1			EVE TO L-1
10TH	(WAK)	WEST	QUI	(EVE)			WOB TO E-1			REV TO L-1
ADDITIONAL		ENGINES: BOS, MED, NEW			LADDERS: BOS, LYN, QUI			Rev Date		Issue Date
() Responding from Coverage Assignment. All Blank Companies above Heavy Line are per Local Runcards							2/1/2023		2024-1	

CHELSEA

Emergency Phone

Business Phone

PRATVILLE STATION

32 Sagamore Av. @ Cheever St.

E1

CENTRAL STATION

307 Chestnut St (Near City Hall)

E2, TL1, Car 3

MILL HILL STATION

883 Broadway near Webster Av.

E3, L2

METROFIRE RUNNING CARD

CHELSEA

MUTUAL AID BOX 8215

FIREGROUND PRIMARY CHANNEL Chelsea Fire Ch. 2 482.2375							ALT. FG Chelsea Fire Ch 3 470.0875			
COVERING PRIMARY CHANNEL Chelsea Fire Ch. 1 470.0250							ALT. COV None			
TO FIRE							COVER			
ALARM	ENGINES			LADDERS	SPECIAL	CHIEFS	ENGINES		LADDER	
1ST							MILL HILL E-3		CENTRAL E-2 & TL-1	
WF				REV "RIT"			REV		EVE	EVE
2ND	(REV)	(EVE)	BOS	(EVE)	MSPRT ENG/ RIT	BOS	SOM		MED	BOS
3RD	(MED)	(SOM)	WINT	(BOS)		SOM	LYN		MAL	MAL
4TH	(LYN)	(MAL)	SAU	(MAL)			MEL		CAM	MED
5TH	(MEL)	(CAM)	BOS	(MED)			BEL		WAK	SOM
6TH	BRK	BOS	CAM	(SOM)						LYN
7TH	STON	WAL	REA	(LYN)						CAM
8TH	WINC	ARL	QUI	(CAM)						BOS
9TH	CAM	WOB	WAT	(BOS)						BRK
10TH	NEW	LEX	WEL	(BRK)						WAL
ADDITIONAL ENGINES: WEST, WEL					LADDERS: NEW, QUI			Rev. Date	Issue Date	
() Responding from Coverage Assignment All Blank Companies above Heavy Line are per Local Runcards							2/1/2021	2024-1		

DEDHAM

Emergency Phone

Business Phone

HEADQUARTERS STATION

26 Bryant St.

E2, E4, L1, Squad 1 (Brush Truck), E5 (Reserve)

EAST DEDHAM STATION

230 Bussey St.

E3, L2 (Reserve), Squad 3 (Haz-Mat supplies)

METROFIRE RUNNING CARD

DEDHAM

MUTUAL AID BOX 8223

FIREGROUND PRIMARY CHANNEL As assigned by Norfolk County Control						ALT. FG Assigned by NCC				
COVERING PRIMARY CHANNEL Dedham Fire Ch. 1 453.6875						ALT. COV None				
TO FIRE						COVER				
ALARM		ENGINES		LADDERS	SPECIAL	CHIEFS		ENGINES		LADDER
1ST							E. Ded. E-3		Headquarters E-2 & L1	
WF							NEE		WESWD*	BOS
2ND	(WESWD)* "RIT"	(NEE)		(BOS)		BOS	BOS		NORWD*	QUI
3RD	(BOS)	MIL	(NORWD)*	(QUI)			QUI		CAN*	NEW
4TH	(QUI)	(CAN)*	WEL	(NEW)			BOS		NEW	BRK
5TH	(BOS)	(NEW)	BRK	(BRK)			BOS		BRA	WAL
6TH	(BOS)	(BRA)	NEW	(WAL)			QUI		WALP*	WAT
7TH	(WALP)*	(QUI)	WAL	(WAT)			WAL		LEX	WESWD*
8TH	(LEX)	(WAL)	STOT*	(WESWD)*			WEST		WEY	BRA
9TH	(WEY)	(WEST)	RAN	(BRA)			BEL		CAM	CAM
10TH	(CAM)	(BEL)	SHA*	(CAM)			ARL		CAM	SOM
ADDITIONAL ENGINES:		SOM, MED, CHE			LADDERS:		MED, WEY			
() Responding from Coverage Assignment. All Blank Companies above Heavy Line are per Local Runcards										
* CAN (Canton), NOR (Norwood), SHA (Sharon), STOT (Stoughton), WALP (Walpole), WESWD (Westwood) CONTACT Thru NORFOLK COUNTY CONTROL								Rev. Date	Issue Date	
								2/1/2023	2024-1	

EVERETT

Emergency Phone

Business Phone

CENTRAL STATION

384 Broadway opposite Second Street

E1, L1

STATION 2

54 Hancock St between Linden & Waverly St.

E2

STATION 3

243 Ferry St. Corner of Elm St.

E3, L2

METROFIRE RUNNING CARD

EVERETT

MUTUAL AID BOX 8216

FIREGROUND PRIMARY CHANNEL Metro Central FIREGROUND							ALT. FG Metro North FIREGROUND @			
COVERING PRIMARY CHANNEL Everett Fire Ch. 1 470.0500							ALT. COV.			
	TO FIRE						COVER			
ALARM	ENGINES			LADDERS	SPECIAL	CHIEFS	ENGINES			LADDER
1ST							CENTRAL E-1	STATION 2 E-2	STATION 3 E-3 & L2	
WF					@@		CHE	MAL	REV	@@
2ND	(CHE)	(MAL)	(REV)	(@@)	SOM ENG	SOM	MED	BOS	MEL	REV
3RD	(MED)	(BOS)	(MEL)	(REV)		BOS	CAM	BOS	SAU	SOM
4TH	(CAM)	(BOS)	(SAU)	(SOM)			CAM	MSPRT	WINT	MED
5TH	(CAM)	(MSPRT)	(WINT)	(MED)			ARL	WINC	LYN	CAM
6TH	(ARL)	(WINC)	(LYN)	(CAM)			NEW	WAK	WAT	LYN
7TH	(NEW)	(WAK)	(WAT)	(LYN)			BEL	WAL	BRK	BRK
8TH	(BEL)	(WAL)	(BRK)	(BRK)			NEW	WOB	STON	BOS
9TH	(NEW)	(WOB)	(STON)	(BOS)			QUI	LEX	REA	NEW
10TH	(QUI)	(LEX)	(REA)	(NEW)			BUR	NEE	WEST	QUI
ADDITIONAL	ENGINES: BOS, CAM, QUI				LADDERS: BOS, WAL		Rev. Date		Issue Date	
() Responding from Coverage Assignment. All Blank Companies above Heavy Line are per Local Runcards							3/6/2023		2024-1	
@@=Assigned as RIT or to Station Coverage Per Local Run Card MAL or CHE Ladder										

LEXINGTON

Emergency Phone

Business Phone

HEADQUARTERS STATION
45 Bedford St

E1, E2, L1, MED 1

EAST LEXINGTON STATION
1006 Massachusetts Av.

E4, MED2

METROFIRE RUNNING CARD

LEXINGTON

MUTUAL AID BOX 8238

FIREGROUND PRIMARY CHANNEL: Lexington Fire Ch. 1 482.0875						ALT. FG Metro North FIREGROUND				
COVERING PRIMARY CHANNEL: Metro North DISTRICT						ALT. Cov NONE				
TO FIRE						COVER				
ALARM	ENGINES		LADDERS	SPECIAL	CHIEFS	ENGINES		LADDER		
1ST						<u>E. Lex</u>		<u>Headquarters</u>		
WF	ARL			BED*		WINC		BUR		
2ND	(WINC)	(BUR)	CON*	WAL		WAL		WOB	CAM	
3RD	(WOB)	(WAL)	HANS*	(CAM)		SOM		CAM		
4TH	(CAM)	(SOM)	BEL	LINC*		WAT		REA	SOM	
5TH	(REA)	(WAT)	WEST	(SOM)		MEL		WAK	NEW	
6TH	(WAK)	(MEL)	STON	(NEW)		CAM		WILM*	WEL	
7TH	(WILM)*	(CAM)	WAL	(WEL)		NEE		BIL*	MED	
8TH	(BIL)*	(NEE)	MED	(MED)		CHE		SAU	BRK	
9TH	(SAU)	(CHE)	NEW	(BRK)		MAL		EVE	EVE	
10TH	(EVE)	(MAL)	DED	(EVE)		REV		LYN	LYN	
ADDITIONAL ENGINES: NEW, BOS				LADDERS: LYN, CHE, BOS						
* BED (BEDFORD), CON (CONCORD), HANS (HANSCOM), LINC (LINCOLN) (CONTACT THRU LEXINGTON)							Rev Date	Issue Date		
() Responding from Coverage Assignment							2/1/2023	2024-1		

LYNN

Emergency Phone

Business Phone

Fire Alarm Phone

HIGHLAND STATION
73 Hollingsworth St

TOWER HILL STATION
659 Boston St.

E1, Medic 1

E9

HEADQUARTERS STATION
725 Western Av.

WYOMA SQUARE STATION
424 Broadway

E3, L2

E10, TL4

Fayette Street Station
101 Fayette St.

E5, L1, H1 (Safety Officer)

PINE HILL STATION
109 Woodlawn St

E7

METROFIRE RUNNING CARD

LYNN

MUTUAL AID BOX 8271

FIREGROUND PRIMARY CHANNEL: Lynn Fire Ch. 2 482.2125							ALT. FG Metro North FIREGROUND			
COVERING PRIMARY CHANNEL: Lynn Fire Ch. 1 470.1750							ALT. COV None			
TO FIRE							COVER			
ALARM		ENGINES		LADDERS	SPECIAL	CHIEF	ENGINES			LADDER
1ST							<u>E-3'S QTR</u>	<u>E-5'S QTR</u>	<u>E-10 QTR</u>	
WF							SAU	SAL*	SWA* FROM SWA	
2ND							MEL	MAR*	PEA*	REV TO L-2
3RD	(SAU)	(SAL*)	SWA*	(REV)			REV	CHE	LYNF*	MAL TO L-2
4TH	(MAR)*	(PEA)*	MEL	(MAL)			BOS	WAK	BEV*	CHE TO L-2
5TH	(REV)	(CHE)	(LYNF*)	(CHE)			MSPRT	WINT	DAN*	BOS TO L-2
6TH	(BOS)	(WAK)	BEV	(BOS)		BOS	MED	BOS	REA	SOM TO L-1
7TH	(MSPRT)	(WINT)	(DAN)	(SOM)			EVE	SOM	STON	EVE TO L-2
8TH	(MED)	(BOS)	(REA)	(EVE)			WOB	CAM	NREA*	MED TO L2
9TH	(EVE)	(SOM)	(STO)	(MED)			ARL	BUR	MID*	CAM TO L-1
10TH	(WOB)	(CAM)	(NREAD*)	(CAM)			WINC	LEX	NAH*	BOS TO L-2

ADDITIONAL ENGINES: BEL, TOP*, WEN* LADDERS: PEA*, SAL*, BRK

() Responding from Coverage Assignment. All Blank Companies above Heavy Line are per Local Runcards.

BEV* (Beverly), DAN* (Danvers), LYNF* (Lynnfield), PEA* (Peabody), MAR* (Marblehead), MID* (Middleton), NAH* (Nahant), NREAD* (North Reading), SAL* (Salem), SWA* (Swampscott), TOP* (Topsfield), WEN* (Wenham), Contact Thru Beverly Control	Rev. Date	Issue Date
	2/1/2024	2024-1.02

MALDEN

Emergency Phone

Business Phone

DISTRICT 1 HEADQUARTERS

1 Sprague St. @ Salem Street (mailing address 1 Sprague, apparatus doors face Salem St)

E1, E2, L1, C2

DISTRICT 3 WEST SIDE

332 Pleasant St. @ Pearl St.

E3, L3

DISTRICT 4 MALDEN/REVERE

5 Overlook Ridge Rd.

E4

METROFIRE RUNNING CARD

MALDEN

MUTUAL AID BOX 8226

FIREGROUND PRIMARY CHANNEL Metro North FIREGROUND							ALTERNATE FG Central FIREGROUND			
COVERING PRIMARY CHANNEL Malden Primary Ch. 1 482.0125							ALTERNATE COV: None			
TO FIRE							COVER			
ALARM	ENGINES			LADDERS	SPECIAL	CHIEFS	ENGINES		LADDER	
1ST							<u>E-4</u>	<u>E-3</u>	<u>Headquarters</u>	
WF										
2ND	LYN "RIT"			LYN "RIT"						
3RD							WAK	STO	CHE	REV
4TH	(CHE)	BOS	WINC	(REV)		BOS			CAM	CHE
5TH	(CAM)	LYN	ARL	(CHE)					WINT	SOM
6TH	(WINT)	BOS	WOB	(SOM)					CAM	BOS
7TH	(CAM)	BEL	BRK	(BOS)					REA	CAM
8TH	(REA)	BOS	WAL	(CAM)					WAT	ARL
9TH	(WAT)	BOS	NEW	(ARL)					QUI	WAL
10TH	(QUI)	LEX	BUR	(WAL)					MSPRT	BRK
ADDITIONAL	ENGINES: PEA*, QUI				LADDERS: BOS, QUI					
() Responding from Coverage Assignment. All Blank Companies above Heavy Line are per Local Runcards								Rev. Date	Issue Date	
* PEA (Peabody) Contact Thru Beverly Control								2/1/2022	2024-1*	

MASSPORT-Hanscom Field

Fire Alarm Emergency Phone

Fire Alarm Business Phone

Hanscom Station 5 Phone

Station 5

Aircraft Rescue and Firefighting (ARFF)

E 51, E52

FT 5 (Foam Trailer 1,000 Gallons 3% AFFF)

Structural

E53

Staging Area Gate 1 (Civilian Air Terminal)

200 Hanscom Dr. Bedford, MA (off of North Great Road Lincoln)

METROFIRE RUNNING CARD

MASSPORT- HANSCOM FIELD

MUTUAL AID BOX 8259

FIREGROUND Primary Channel Metro North DISTRICT

ADDITIONAL OPERATIONS CHANNELS: See ICS 205

To STAGING at GATE 1 or as Otherwise Directed

ALARM	ENGINES				LADDERS	SPECIAL		AMB	CHIEFS	
STILL	MSPRT	HAFB*							MSPRT	
1ST	HAFB*	CON*	BED*	LIN*	LEX	HAFB* RES	MSPRT FTF-3 ALERT 3	ARMST AMBU	USAF LIN-LEX	CON-BED
2ND	WAL	BEL	BUR	WEST	WAL	WAL RES	DFS ISU	MCI	WAL	
3RD	ARL	NEW	WINC		NEW	CAM RES		MCI	CAM	
4TH	WOB	STON			CAM			MCI		
5TH	REA	WEL			MED			MCI		
6TH	NEE	WAK			BOS			MCI	BOS	
7TH	CAM	NEW			SOM			MCI		
8TH	BOS	REV			EVE			MCI		
9TH	BOS	BOS			BOS			MCI		

ADDITIONAL ENGINES: BEDFORD, LEXINGTON

ADDITIONAL LADDERS: BEDFORD, CONCORD

BEDFORD-DISTRICT 6 CONTACT DIRECT (781)275-1212 CONCORD - DISTRICT 14 CONTACT DIRECT (978)318-3400

LINCOLN- DISTRICT 14 CONTACT DIRECT (781)259-8111

****STAGING AT GATE 1 (Civilian Air Terminal)- GPS INFO - NORTH GREAT ROAD LINCOLN TO
HANSCOM DRIVE BEDFORD MA FOLLOW WAY FINDING STAGING AREA SIGNS****

Rev. Date

Issue Date

3/24/2022

2024-1

MASSPORT-Logan International Airport

Emergency Phone

Fire Alarm Business Phone

Station 1 HEADQUARTERS- 162 Harborside Dr. East Boston

Structural E1 (250 Gal AR-AFFF & 250 Gal AFFF), E2, T1, R1

Aircraft Rescue & Firefighting (ARFF)

E3, E4, E7

Stair Truck 1 (Mobile Air Stairs), Hazmat 1 (WMD/Hazmat), Mass Decon Unit

FT1 Foam Trailer (750 Gal. AFFF Foam & 450# of Dry Chem)

FT2 Foam Trailer (750 Gal. AR AFFF Foam & 450# of Dry Chem)

Station 2-Perimeter Road (Airfield side)

E5, E6

Marine Rescue Station 3- 1 Harborside Dr. Rear

M31 80' Fireboat – 6,000 GPM, (500 Gal AR AFFF)

M32 37' Fireboat – 500 GPM

M33 25' Rescue Boat

Staging

Box 646 North Gate 200 Prescott St. East Boston - PRIMARY

Box 642 South Gate 158 Harborside Dr. East Boston

Tomahawk Staging – 40 Tomahawk Drive East Boston

METROFIRE RUNNING CARD

MASSPORT-LOGAN

MUTUAL AID BOX 8211

FIREGROUND Primary CHANNEL Massport Fire FD 1 453.9000
ALT FIREGROUND CHANNEL Metro Central FIREGROUND

COVER: NORTH GATE
WINT ENG - CHE TL-1

Still Alarm
1ST
2ND
3RD
4TH
5TH

Box 646 -North Gate Staging Massport & Boston Runcards
200 Prescott St. East Boston-PRIMARY
Box 642 South Gate Staging Massport & Boston Runcards
158 Harborside Dr. East Boston

LOGAN AIRPORT TASK FORCES

	ENGINES				LADDERS			SPECIALS	CHIEFS
TF 1	WINT	REV	EVE	CAM	CHE	REV	EVE	CHE RESCUE	CHE
TF 2	SOM	CAM	MED	MAL	CAM	MED	SOM	CAM RESCUE	SOM
TF 3	SAU	LYN	NEW	WINC	LYN	MAL	SAU	SOM RESCUE	LYN
								Rev. Date	Issue Date
								3/24/2022	2024-1

MEDFORD

Emergency Phone

Business Phone

HEADQUARTERS-120 Main St. @ Mystic Av.

E1, L1

STATION 2 WEST MEDFORD-26 Harvard Av. @ Bower St.

E2

STATION 3- 276 Salem St. @ Park St.

E3, L2

STATION 4 RIVERSIDE- 435 Riverside Av. @ Commercial St.

E4

STATION 5 SOUTH MEDFORD- 0 Medford St near Main St.

E5

STATION 6 FULTON HEIGHTS- 2 Ames St @ Fulton St.

E6

METROFIRE RUNNING CARD

MEDFORD

MUTUAL AID BOX

8228

FIREGROUND CHANNEL Primary Metro North FIREGROUND						Alternate: FG Metro Central FIREGROUND				
COVERING COMPANY CHANNEL Medford Fire Ch. 1 482.1375						Alternate COV: NONE				
TO FIRE						COVER				
ALARM	ENGINES			LADDERS	SPECIAL	CHIEFS	ENGINES		LADDER	
1ST							HEADQUARTERS			
WF										MAL
2ND				(MAL)						SOM
3RD				(SOM) CHE			EVE	CHE	STON	EVE
4TH	(EVE)	(CHE)	REV	(EVE)			MEL	WINC		CAM
5TH	(MEL)	(WINC)	CAM	(CAM)			WOB	BOS		BOS
6TH	(WOB)	(BOS)	BOS	(BOS)		BOS	BEL	MSPRT		WAT
7TH	(BEL)	(MSPRT)	READ	(WAT)			WAL	BOS		WAL
8TH	(WAL)	(BOS)	WAK	(WAL)			LYN	SAU		LYN
9TH	(LYN)	(SAU)	BRK	(LYN)			WINT	LEX		NEW
10TH	(WINT)	(LEX)	BUR	(NEW)			CAM	NEW		BOS
ADDITIONAL	Engines: WAL, BOS				Ladders: BRK			Rev. Date	Issue Date	
() Responding from Coverage Assignment. All Blank Companies above Heavy Line are per Local Runcards								3/1/2023	2024-1	

MELROSE

Emergency Phone

Business Phone

HEADQUARTERS STATION (DISTRICT 1)

576 Main St. (Next to City Hall)

L1, R1, R2, C2

DISTRICT 2

206 Tremont St. @ Melrose St.

E2, L2 (Reserve)

DISTRICT 3

280 East Foster St. near Sixth St.

E3, E4 (Reserve)

METROFIRE RUNNING CARD

MELROSE

MUTUAL AID BOX 8227

FIREGROUND PRIMARY CHANNEL Metro North FIREGROUND							ALTERNATE FG Central FIREGROUND			
COVERING PRIMARY CHANNEL Melrose Fire Ch. 1 482.1500							ALTERNATE COV: None			
TO FIRE							COVER			
ALARM		ENGINES		LADDERS	SPECIAL	CHIEFS	ENGINES			LADDER
1ST							HEADQUARTERS			
WF							SAU	MAL		MAL
2ND	(SAU)	(MAL)	STON	(MAL)	WAK ENG "RIT"		EVE	REA		EVE
3RD	(EVE)	(REA)	SOM	(EVE)	MED LAD "RIT"	SOM	CHE	WOB		CHE
4TH	(CHE)	(WOB)	WINC	(CHE)			LYN	MED		SOM
5TH	(LYN)	REV	CAM	(SOM)		CAM	BOS			LYN
6TH	(BOS)	LEX	ARL	(LYN)		BOS	BUR			REV
7TH	(BUR)	NREA*	BEL	(REV)			LYN			BOS
8TH	(LYN)	LYNF*	BOS	(BOS)			CAM			CAM
9TH	(CAM)	WINT	MSPRT	(CAM)			WAL			WAL
10TH	(WAL)	WAT	NEW	(WAL)			BRK			NEW
ADDITIONAL	ENGINES: BOS, CAMB, WAL				LADDERS: BOS					
() Responding from Coverage Assignment. All Blank Companies above Heavy Line are per Local Runcards							Rev. Date	Issue Date		
NREA* (N. Reading), LYNF* (Lynnfield) (Contact Beverly Control)							2/1/2023	2024-1		

MILTON

Emergency Phone

Business Phone

HEADQUARTERS STATION
1 Engine Rd.

E1, L1

EAST MILTON STATION
525 Adams St. East Milton Square

E2

BLUE HILL STATION
815 Blue Hill Av. @ Atherton St.

E4

METROFIRE RUNNING CARD

MILTON

MUTUAL AID BOX 8224

FIREGROUND PRIMARY CHANNEL As Assigned by Norfolk County Control						ALT. FG As Assigned by NCC				
COVERING PRIMARY CHANNEL Milton Fire Ch. 1 482.0750						ALT. COV None				
	TO FIRE					COVER				
ALARM		ENGINES		LADDERS	SPECIAL	CHIEFS	ENGINES			LADDER
1ST							<u>Headquarters</u>			
WF							CAN*			RAN
2ND	CAN *			RAN			BOS			BOS
3RD	(BOS)			(BOS)		BOS	QUI			STOT*
4TH	(QUI)	BOS		(STOT) *			BRA			DED
5TH	(BRA)	BOS		(DED)			NEE			BRK
6TH	(NEE)	WEY		(BRK)			WESWD*			NEW
7TH	(WESWD)*	BRK		(NEW)			WEL			CAM
8TH	BOS	NEW		WAL						
9TH	NEW	QUI		SOM						
10TH	BOS	RAN		MED						
ADDITIONAL ENGINES: DED, WAL						LADDERS: BRKTN* EVE				
() Responding from Coverage Assignment. All Blank Companies above Heavy Line are per Local Runcards								REV Date	Issue Date	
*CAN (Canton), WSTWD (Westwood), BRKTN (Brockton), STOT (Stoughton) Contact thru Norfolk County Control								3/1/2023	2024-1	

NEEDHAM

Emergency Phone

Business Phone

HEADQUARTERS STATION

88 Chestnut St. @ School St.

E1, E3 (Quint), R1,

HEIGHTS STATION

707 Highland Av @ Webster St

E2, L1 (Quint),
Regional Foam Attack Trailer

METROFIRE RUNNING CARD

NEEDHAM

MUTUAL AID BOX 8242

FIREGROUND PRIMARY CHANNEL Needham Ch. 1 453.0750							ALT. FG Metro South FIREGROUND			
COVERING PRIMARY CHANNEL Metro South DISTRICT@										
TO FIRE							COVER			
ALARM	ENGINES			LADDERS	SPECIAL	CHIEFS	ENGINES			LADDER
1ST							<u>STA-2</u>	<u>Headquarters</u>		
WF							NEW	WESWD*	WEL	DED
2ND		(WESWD*)	(WEL)	(DED)				DED	BRK	NEW
3RD	(NEW)	(DED)	(BRK)	(NEW)			WEST	BOS	NORWD*	NAT**
4TH	NEW	BOS	QUI	BRK		BOS				
5TH	MIL	WAT	WAL	QUI						
6TH	BRA	QUI	BOS	WAL						
7TH	CAM	WAL	RAN	CAM						
8TH	BEL	LEX	SOM	BOS						
9TH	BOS	CAM	BUR	SOM						
10TH	WOB	ARL	MED	WEST						
ADDITIONAL ENGINES:		MAL, EVE			LADDERS:		MED, EVE			
() Responding from Coverage Assignment. All Blank Companies above Heavy Line are per Local Runcards								Rev. Date	Issue Date	
* WESWD (WESTWOOD), NORWD (NORWOOD), (CONTACT NORFOLK COUNTY CONTROL) **NAT (Natick) Notify Thru Dist								3/1/2023	2024-1	

NEWTON

Emergency Phone

Business Phone

STATION 1 NEWTON CORNER- 241 Church St.

E1, L3

STATION 2 WEST NEWTON- 1750 Commonwealth Av.

E2, L1, MDU (Mass Decon), Special OPS W/Boat, Medic 2

STATION 3 NEWTON CENTRE- 31 Willow St.

E3, R1, Medic 1, Medic Supervisor (FS1), ERU

STATION 4 NEWTONVILLE- 195 Craft St.

E4, Medic 3, Lighting Plant

STATION 7 NEWTON UPPER FALLS- 144 Elliot St.

E7, L2, Medic 4

STATION 10 OAK HILL- 755 Dedham St.

E10

METROFIRE RUNNING CARD

NEWTON

MUTUAL AID BOX 8221

FIREGROUND PRIMARY CHANNEL Newton Ch. 1 482.9625						ALT. FG Newton Ch. 2 483.4625				
COVERING PRIMARY CHANNEL Newton Ch. 2 483.4625						ALT. COV. Metro North DISTRICT				
TO FIRE						COVER				
ALARM	ENGINES			LADDERS	SPECIAL	CHIEFS	ENGINES		LADDER	
1ST										
WF										
2ND										
3RD										
4TH	(WAT)	(WEST)	(WEL)	(WAL)			BOS TO E-1	CAM TO E-2	DED TO E-7	BOS TO L-3
5TH	(BRK)	(NEE)	(WAL)	(BRK)			BEL TO E-3	WAL TO E-4	BOS TO E-10	CAM TO L-2
6TH	(BOS)	(CAM)	(DED)	(BOS)			BOS TO E-1	CAM TO E-2	QUI TO E-7	SOM TO L-3
7TH	(BEL)	(WAL)	(BOS)	(CAM)			CAM TO E-3	SOM TO E-4	MIL TO E-10	QUI TO L-2
8TH	(BOS)	(CAM)	(QUI)	(SOM)			MED TO E-1	ARL TO E-2	WOB TO E-7	MAL TO L-3
9TH	(CAM)	(SOM)	(MIL)	(QUI)			QUI TO E-3	LEX TO E-4	BOS TO E-10	DED TO L-2
10TH	(MED)	(ARL)	(WOB)	(MAL)			EVE TO E-1	BRA TO E-2	MAL TO E-7	MED TO L-3
ADDITIONAL	ENGINES: WINC, STO, MEL			LADDERS: BOS, EVE			Rev. Date	Issue Date		
() Responding from Coverage Assignment. All Blank Companies above Heavy Line are per Local Runcards							2/1/2023	2024-1		

QUINCY

Emergency Phone

Business Phone

HEADQUARTER STATION

40 Quincy St.
E1, L1, R1 (Heavy Rescue),

ATLANTIC STATION

311 Hancock St.
E2, L5

QUINCY POINT STATION

615 Washington St.
E3, H2 Hazmat

WOLLASTON STATION

111 Beale St
E4, L2

WEST QUINCY STATION

182 Copeland St.
E5, Special Service Unit (Brush Truck)

HOUGHES NECK STATION

1082 Sea St.
E6, L4

SQUANTUM STATION

86 Huckins Av.
E7

GERMANTOWN STATION

126 Doane St.
E8

METROFIRE RUNNING CARD

QUINCY

MUTUAL AID BOX 8225

FIREGROUND PRIMARY CHANNEL Quincy Fire Ch. 2 484.8000						ALT. FG Quincy Fire Ch 3 453.3125				
COVERING PRIMARY CHANNEL Quincy Fire Ch. 1 483.5375						ALT. COV				
	TO FIRE					COVER				
ALARM	ENGINES			LADDERS	SPECIAL	CHIEFS	ENGINES		LADDER	
1ST										
WF										
2ND							WEY TO E-3	BOS TO E-2	BOS TO L-5	
3RD							MIL TO E-6	BRA TO E-5	(BOS) @L5 TO L-1 BOS TO L-5	
4TH	QUI	(BOS)		(BOS)		BOS	BRA TO E-1	RAN TO E-5	BOS TO E2	BRA TO L-1
5TH	(BRA)	(RAN)		(BRA)			DED TO E-1	CAN* TO E-5		NORWD* TO L-1
6TH	(DED)	(CAN)*		(NORWD)*			BOS TO E-1	BRK TO E-5		DED TO L-1
7TH	(BOS)	(BRK)		(DED)			NEW TO E-1	CAM TO E-5		NEE TO L-1
8TH	(NEW)	(CAM)		(NEE)			BOS TO E-1	WEL TO E-5		BRK TO L-1
9TH	(BOS)	(WEL)		(BRK)			NEW TO E-1	SOM TO E-5		WAL TO L-1
10TH	(NEW)	(SOM)		(WAL)			CAM TO E-1	WAT TO E-5		CAM TO L-1
ADDITIONAL	ENGINES: MED,BEL,CHE,EVE,WALP				LADDERS: THRU NORFOLK COUNTY CONTROL					
() Responding from Coverage. All Blank Companies above Heavy Line are per Local Runcards								Rev. Date	Issue Date	
*CAN (CANTON), NORWD (NORWOOD) (CONTACT THRU NORFOLK COUNTY CONTROL).								2/1/2024	2024-1	

RANDOLPH

Emergency Phone

Business

**HEADQUARTERS (Central)
10 Memorial Parkway**

C3, E1, E3, A1, A2,

**NORTH RANDOLPH FIRE STATION (Station 2)
952 North Main St. (Route 28)**

E2, A3, TL1, Squad 2 Forestry Brush ,

METROFIRE RUNNING CARD

RANDOLPH

MUTUAL AID BOX 8243

FIREGROUND PRIMARY CHANNEL Assigned by Norfolk County Control						ALT. FG Assigned by NCC			
COVERING PRIMARY CHANNEL Randolph Fire Primary Ch. 1 483.6625						ALT. COV None			
	TO FIRE					COVER			
ALARM	ENGINES			LADDERS	SPECIAL	CHIEFS	ENGINES		LADDER
1ST							<u>HQ</u>		<u>STATION 2</u>
WF			HOL*				BRA		MIL AVO*
2ND	(BRA)	(MIL)		(AVO*)			WEY		CAN* STOT*
3RD	(WEY)	(CAN*)		(STOT*)			DED		QUI BRKTN*
4TH	(DED)	(QUI)		(BRKTN*)	ISU & REHAB		FOX*		NORWD* SHA*
5TH	BOS	QUI		BOS		BOS			
6TH	BRKTN*	ABI*		WESWD*					
7TH	NEED	ROC*		EAS*					
8TH	WALP*	NEW		BRK					
9TH	WEL	CHE		CAM					
10TH	EVE	BOS		WHI*					
ADDITIONAL ENGINES: WAL, BRK, NEW, HIN*, SOM LADDERS: WEY, QUI									
() Responding from Coverage Assignment. All Blank Companies above Heavy Line are per Local Runcards									
*AVO (Avon), BRKTN (Brockton), CAN (Canton), FOX (Foxborough), HIN (Hingham), HOL (Holbrook), NORWD (Norwood), SHA (Sharon), STOT (Stoughton), WALP (Walpole), WESWD (Westwood), WHIT (Whitman) Contact Thru Norfolk County Control							Rev. Date	Issue Date	
							2/1/2022	2024-1	

READING

Emergency Phone

Business Phone

**HEADQUARTERS STATION
757 Main St.**

E1, L1, R1

**WEST SIDE STATION
267 Woburn St.**

E2

METROFIRE RUNNING CARD

READING

MUTUAL AID BOX 8235

FIREGROUND PRIMARY CHANNEL Reading Fire Ch. 1 483.4125							ALT. FG Metro North FIREGROUND			
COVERING PRIMARY CHANNEL Metro North DISTRICT							ALT. COVER None			
TO FIRE							COVER			
ALARM		ENGINES		LADDERS	SPECIAL	CHIEFS		ENGINES	LADDER	
1ST							WEST SIDE E-2	<u>HEADQUARTERS E-1</u>		
WF	STON "RIT"						WOB	WAK		
2ND	(WAK)	(WOB)		NREA*			BUR	MEL	WIL**	LYNF*
3RD	(MEL)	(WIL**)	(BUR)	(LYNF*)	DFS REHAB		WINC	AND*	SAU	LAW*
4TH	AND*	(SAU)	(WINC)	(LAW*)	DFS ISU		LEX	LYN	MED	DAN*
5TH	(LEX)	(MED)	(LYN)	(DAN*)			ARL	EVE	MAL	SOM TL
6TH	(ARL)	(EVE)	(MAL)	(SOM TL)			REV	CHE	PEA*	
7TH	(CHE)	(PEA)*	(REV)				WAL	BEL	MID*	BOS
8TH	(BEL)	(WAL)	(MID*)	(BOS)		BOS	WAT	SAL*	CAM	
9TH	(SAL*)	(CAM)	(WAT)				WEST	BEV*	NEW	
10TH	(WEST)	(NEW)	(BEV*)				TEW**	BOS	MSPRT	
ADDITIONAL	Engines: NAND*, TEW**, DAN*				LADDERS: CAM, LYN TOWER, CHE(TL)					
() Responding from Cover Assignment. All Blank boxes above Heavy Line are per Local Runcards										
* AND (Andover), BEV (Beverley), DAN (Danvers), LAW (Lawrence), LYNF (Lynnfield), PEA (Peabody), MID (Middleton), NAND (North Andover), SAL (Salem) Contact Beverley Control ** WIL (Wilmington), TEW (Tewksbury) Contact Westford Control								Rev Date	Issue Date	
								2/1/2024	2024-1	

REVERE

Emergency Phone

Business Phone

PARKWAY STATION

360 Revere Beach Parkway (Route 16)

E1, L1, ORU 22 (DFS Haz-Mat Truck 22)

NORTH REVERE STATION

3 Overlook Ridge Dr. off Salem St.

E3

CENTRAL STATION-HEADQUARTERS

400 Broadway Opposite Central Av.

E4, L2

FREEMAN STREET STATION

4 Freeman St. @ North Shore Road

E5

METROFIRE RUNNING CARD

REVERE

MUTUAL AID BOX 8214

FIREGROUND PRIMARY CHANNEL METRO Central FIREGROUND						ALT. FG METRO North FIREGROUND				
COVERING PRIMARY CHANNEL Revere Fire Ch. 1 470.0625						ALT. COV				
TO FIRE						COVER				
ALARM	ENGINES			LADDERS	SPECIAL	CHIEFS	ENGINES	LADDER		
1ST	SEE COMMUNITY RUN CARDS						PARKWAY E-1	FREEMAN E-5	Headquarters E-4 & L2	
W/F	SEE COMMUNITY RUN CARDS			CHE LAD "RIT"			WINT	MAL	CHE	EVE
2ND	(WINT)	(CHE)	(MAL)	(EVE)	MSPRT ENG "RIT"	C1/C2	EVE	LYN	SAU	MAL
3RD	(EVE)	(SAU)	(LYN)	(MAL)			BOS	LYN	CAM	LYN
4TH	(BOS)	(CAM)	(LYN)	(LYN)			SOM	MEL	MED	MED
5TH	(SOM)	(MED)	(MEL)	(MED)			BOS	WAK	ARL	SOM
6TH	(BOS)	(ARL)	(WAK)	(SOM)			BOS	STON	BEL	BOS
7TH	(BOS)	(BEL)	(STON)	(BOS)			BRK	WOB	CAM	CAM
8TH	(BRK)	(CAM)	(WOB)	(CAM)			WAL	REA	BUR	BRK
9TH	(WAL)	(BUR)	(REA)	(BRK)			WAT	LEX	NEW	NEW
10TH	(WAT)	(NEW)	(LEX)	(NEW)			WEL	MIL	QUI	QUI
ADDITIONAL	Engines: BOS, BOS, NEW, WAL, NEE,				LADDERS: BOS, WAL				Rev. Date	Issue Date
() Responding from Coverage Assignment All Blank Companies above Heavy Line are per Local Runcards								5/9/2023	2024-1	

SAUGUS

Emergency Phone

Business Phone

CENTRAL STATION

27 Hamilton St

E3, L1, R1

CLIFTONDALE STATION

120 Essex St Opposite School St.

E1

METROFIRE RUNNING CARD

SAUGUS

MUTUAL AID BOX 8274

FIREGROUND PRIMARY CHANNEL Metro North FIREGROUND							ALT. FG Metro South FIREGROUND				
COVERING PRIMARY CHANNEL Saugus Fire Primary Ch. 1 482.2625							ALT. COV. None				
	TO FIRE						COVER				
ALARM	ENGINES			LADDERS	SPECIAL	CHIEFS	ENGINES			LADDER	
1ST							<u>CLIFTON- DALE</u>		<u>CENTRAL</u>		
WF	WAK "RIT"						MEL		LYN	MAL	
2ND	(MEL)	(LYN)	STON		(MAL)		MAL		REV	REV	
3RD	(MAL)	(REV)	DAN*		(REV)	LYNF* TOWER	CHE		EVE	EVE	
4TH	(EVE)	(CHE)	LYN		(EVE)		WINT		MED	CHE	
5TH	(MED)	(WINT)	BOS		(CHE)		BOS	BUR		REA	WOB
6TH	(BUR)	(REA)	BOS		(WOB)			LEX		SOM	SOM
7TH	(LEX)	(SOM)	CAM		(SOM)			WINC		ARL	CAM
8TH	(WINC)	(ARL)	BEL		(CAM)			WAL		PEA*	MED
9TH	(PEA*)	(WAL)	CAM		(MED)			WAL		WAT	BOS
10TH	(WAL)	(WAT)	WEST		(BOS)			BOS		BRK	BRK
ADDITIONAL	ENGINES: NEW,BOS			LADDERS: NEW, WAL							
() Responding from Coverage Assignment. All Blank Companies above Heavy Line are per Local Runcards									Rev. Date	Issue Date	
*DAN (Danvers), LYNF (Lynnfield), PEA (Peabody) Contact Thru Beverley Control									2/1/2022	2024-1	

SOMERVILLE

Emergency Phone

Business Phone

HEADQUARTERS STATION

266 Broadway @ Walnut St.

E2, L2, R1 (Heavy Rescue)

UNION SQUARE STATION

255 Somerville Av.

E3

LOWELL STREET STATION

651 Somerville Av. @ Lowell St.

E1, T1

TEELE SQUARE STATION

6 Newbury St @ Holland St.

E6, L3

HIGHLAND AVENUE STATION

265 Highland Av. Opposite Conwell St.

E7

METROFIRE RUNNING CARD

SOMERVILLE

MUTUAL AID BOX 8217

FIREGROUND PRIMARY CHANNEL SOMERVILLE Fire Ch. 2 483.2625						ALT. Metro Central FIREGROUND			
COVERING PRIMARY CHANNEL SOMERVILLE Fire Ch. 1 483.3875						ALT. Cov			
	TO FIRE					COVER			
ALARM	ENGINES			LADDERS	SPECIAL	CHIEFS	ENGINES		LADDER
1ST							<u>E-2</u>	<u>E-3</u>	<u>E-7</u>
WF								BOS	
2ND									
3RD	(BOS)					BOS		BOS	
4TH									BOS TO T-1
5TH	COV ENG FROM E-2	COV ENG FROM E-7	BRK	(EVE)			STON		WAT MAL TO L-2
6TH	(STON)	(WAT)	MEL	(MAL)			WINC		WAL BRK TO L-2
7TH	(WINC)	(WAL)	WAK	(BRK)			WINT		WOB REV TO L-2
8TH	(WINT)	(WOB)	SAU	(REV)			NEW		MSPRT NEW TO L-2
9TH	(NEW)	(MSPRT)	REA	(NEW)			LYN		WAL LYN TO L-2
10TH	(LYN)	(WAL)	WEL	(LYN)			NEW		WEST WAL TO L-2
ADDITIONAL	ENGINES: NEE, BUR			LADDERS: QUI				Rev Date	Issue Date
() Responding from Coverage Assignment. All Blank Companies above Heavy Line are per Local Runcards								2/1/2024	2024-1

STONEHAM

Emergency Phone

Business Phone

HEADQUARTERS STATION
25 Central St. @ Emerson St.

E2, E3, E5, L1 (Quint)

METROFIRE RUNNING CARD

STONEHAM

MUTUAL AID BOX 8234

FIREGROUND PRIMARY CHANNEL Metro North FIREGROUND						ALT FG. Metro South FIREGROUND				
COVERING PRIMARY CHANNEL Stoneham Fire Ch. 1 460.6250										
TO FIRE						COVER				
ALARM		ENGINES		LADDERS	SPECIAL	CHIEFS		ENGINES		LADDER
1ST							HQ E-2	HQ E-3		HQ
WF	WINC "RIT"						WAK	REA		
2ND	(WAK)	(REA)	MEL	WOB	REHAB A-10		SAU	MED		MAL
3RD	(SAU)	(MED)	BUR	(MAL)	WIL* "RIT"		NREA*	MAL		MED
4TH	(NREA)**	LYNF**	REV	SOM			EVE			
5TH	(EVE)	LEX	SOM	CHE			ARL			
6TH	(ARL)	CAM	LYN	REV			BEL			
7TH	(BEL)	WINT	CHE	CAM			BOS			
8TH	(BOS)	MSPRT	PEA**	EVE			TEW*			
9TH	(TEW)*	WAL	BOS	LYN			WAT			
10TH	(WAT)	NEW	BRK	BOS			QUI			
ADDITIONAL ENGINES:		BOS		LADDERS:		BOS, LYNF*				
<input type="checkbox"/> Responding from Coverage Assignment All Blank Companies above Heavy Line are per Local Runcards										
*WIL (Wilmington), TEW (Tewksbury) Contact Thru WESTFORD CONTROL ** NREA (North Reading), LYNF (Lynnfield), PEA (Peabody) Contract Thru BEVERLY CONTROL								Rev. Date	Issue Date	
								2/1/2022	2024-1	

WAKEFIELD

Emergency Phone

Business Phone

HEADQUARTERS

Crescent Street @ Princess Street

E1, L1

GREENWOOD STATION

5 Oak St. near Main St.

E2,

METROFIRE RUNNING CARD

WAKEFIELD

MUTUAL AID BOX 8233

FIREGROUND PRIMARY CHANNEL Wakefield Fire Ch. 1 483.4375						ALT. FG Metro North FIREGROUND				
COVERING PRIMARY CHANNEL Metro North DISTRICT						ALT. COV None				
	TO FIRE					COVER				
ALARM	ENGINES			LADDERS	SPECIAL	CHIEFS	ENGINES		LADDER	
1ST							<u>Headquarters</u>			
WF										
2ND	REA	STON	MEL	NREA			SAU	WOB	LYNF*	
3RD	(SAU)	(WOB)	MID*	(LYNF*)			MAL	WIL**	MAL	
4TH	(MAL)	(WIL)**	WINC	(MAL)			DAN*	LYN	BUR-TL	
5TH	(DAN)	(LYN)	PEA*	(BUR) TL			REV	LEX	REV	
6TH	(REV)	(LEX)	SOM	(REV)			EVE	ARL	EVE	
7TH	(EVE)	(ARL)	SAL*	(EVE)			MED	MSPRT	MED	
8TH	(MED)	(MSPRT)	BEV*	(MED)			CHE	WAL	CHE-TL	
9TH	(CHE)	(WAL)	SWA*	(CHE) TL			BEL	CAM	SOM-TL	
10TH	(BEL)	(CAM)	MAR*	(SOM) TL			BOS	WAT	BOS	
ADDITIONAL	ENGINES: CAM, BOS, WAL			LADDERS: CAMB, WAL, BOS						
() Responding from Coverage Assignment. All Blank Companies above Heavy Line are per Local Runcards										
*BEV (Beverley), DAN (Danvers), LYNF (Lynnfield), MAR (Marblehead), MID (Middleton), NREA (N. Reading), PEA (Peabody), SAL (Salem), SWA (Swampscott), Contact Thru BEVERLY CONTROL							Rev Date	Issue Date		
							2/1/2022	2024-1		
** WIL (Wilmington) Contact Thru WESTFORD CONTROL										

WALTHAM

Emergency Phone

Business Phone

**MOODY STREET STATION- 533 Moody St.
E1, SQ5, L2**

**HEADQUARTERS STATION- 175 Lexington St @ Waltham Municipal Complex
E2, TL1, R6 (Heavy Rescue)**

**WILLOW STREET STATION- 67 Willow Street
E3**

**PROSPECT STREET STATION- 35 Prospect St. @ Vernon St.
E4**

**LAKE STREET STATION- 104 Lake St. @ Indian Rd.
E7**

**TRAPELO ROAD STATION- 699 Trapelo Rd. @ Woburn St.
E8**

METROFIRE RUNNING CARD

WALTHAM

MUTUAL AID BOX 8232

FIREGROUND PRIMARY CHANNEL Waltham Fire Ch. 2 482.2250						ALT. FG Waltham Ch. 1				
COVERING PRIMARY CHANNEL Waltham Fire Ch. 1 470.1125						ALT. COV Metro North DISTRICT				
TO FIRE						COVER				
ALARM	ENGINES			LADDERS	SPECIAL	CHIEFS	ENGINES		LADDER	
1ST							<u>Moody</u> <u>St</u>	<u>HQ</u>		
WF										
2ND							NEW	LEX	WEST to E4 BEL to E8	WAT to L1 NEW to L2
3RD		(To be assigned)	(To be assigned)	(To Be assigned)	CAM-L "RIT"		CAM	ARL	NEW & WEL To be Assigned	WEST to be Assigned
4TH	(To be assigned)	(To be assigned)	(CAM)	(To be assigned)			BOS	BRK	CAM To be Assigned	NEE to be Assigned
5TH	(ARL)	(WEL)	(NEW)	(WEST)			BOS	NEE	SOM To be Assigned	SOM To be Assigned
6TH	(BOS)	(BRK)	(CAM)	(NEE)		BOS	BUR	WIN	WOB To be Assigned	BRK To be Assigned
7TH	(BOS)	(NEE)	(SOM)	(SOM)			MAL	MED	DED To be Assigned	BOS To be Assigned
8TH	(BUR)	(WIN)	(WOB)	(BRK)			EVE	BOS	REA To be Assigned	MED To be Assigned
9TH	(MAL)	(MED)	(DED)	(BOS)			WAK	CAM	MEL To be Assigned	EVE To be Assigned
10TH	(EVE)	(BOS)	(REA)	(MED)			MIL	SAU	STON To be Assigned	DED To be Assigned
ADDITIONAL	ENGINES: LYNN, REV, QUIN				LADDERS: BOS		Rev. Date		Issue Date	
() Responding from Coverage Assignment. All Blank Companies above Heavy Line are per Local Runcards							4/26/2023	2024-1		

WATERTOWN

Emergency Phone

Business Phone

**HEADQUARTERS STATION
99 Main St.**

E1, L1

**STATION 2 EAST WATERTOWN STATION
564 Mount Auburn St.**

E2, L2

**STATION 3 NORTH WATERTOWN STATION
270 Orchard St.**

E3, MEDIC 1

METROFIRE RUNNING CARD

WATERTOWN

MUTUAL AID BOX 8219

FIREGROUND PRIMARY CHANNEL Watertown "Fireground" 483.7125						ALT. FG Watertown "Dispatch"			
COVERING PRIMARY CHANNEL Watertown Fire "Dispatch" 482.1250						ALT. COV Metro North DISTRICT			
TO FIRE						COVER			
ALARM	ENGINES		LADDERS	SPECIAL	CHIEFS	ENGINES		LADDER	
1ST						<u>STA 2</u>		<u>Headquarters</u>	
WF						CAM		NEW	WAL
2ND	(NEW)	@@		(WAL)	RIT ASSIGNED			BOS	NEW
3RD	(CAM)	@@	WEST	(NEW)	NEW Air Supply	ARL			BOS
4TH	(BOS)	SOM	LEX	(BOS)		BOS		BRK	CAM
5TH	(ARL)	WEL	BOS	(CAM)			WINC		BRK
6TH	(BRK)	BOS	MED	(BRK)				NEE	SOM
7TH	(WINC)	MEL	MAL	(SOM)			WOB		MED
8TH	(NEE)	WAK	STON	(MED)				EVE	MAL
9TH	(WOB)	MIL	DED	(MAL)			QUI		DED
10TH	(EVE)	REA	BUR	(DED)				RAN	BOS
ADDITIONAL	ENGINES: REV, CHE, MSPRT, SAU, LYN,			LADDERS: REV, CHE, QUI, BRA,			Rev. Date	Issue Date	
() Responding from Coverage Assignment. All Blank Companies above Heavy Line are per Local Runcards							2/1/2024	2024-1	
Special Notes: @@=Assigned to Fire or RIT -----Per Local Run Card Engines BEL, CAM, WAL									

WELLESLEY

Emergency Phone

Business Phone

**WELLESLEY SQUARE STATION
100 Central St.**

E1

**WELLESLEY HILLS STATION – HEADQUARTERS
457 Worcester St. (Route 9)**

E2, Quint 3, Tower 2

METROFIRE RUNNING CARD

WELLESLEY

MUTUAL AID BOX 8241

FIREGROUND PRIMARY CHANNEL Wellesley Fire Ch. 1 482.5750						ALT. FG Metro SOUTH FIREGROUND@				
COVERING PRIMARY CHANNEL Metro South DISTRICT						ALT. COV				
	TO FIRE					COVERAGE				
ALARM	ENGINES			LADDERS	SPECIAL	CHIEFS	ENGINES		LADDER	
1ST							<u>Headquarters</u>			
WF										
2ND										
3RD										
4TH	(DED)	(WAL)		(WAL)			WAT	**FRA		BRK
5TH	(WAT)	(**FRA)		(BRK)			*WESWD	BOS		BOS
6TH	*(WESWD)	(BOS)		(BOS)		BOS	LEX	CAM		CAM
7TH	(LEX)	(CAM)		(CAM)			QUI	MIL		DED
8TH	(QUI)	(MIL)		(DED)			NEW	**NAT		**FRA
9TH	(NEW)	(**NAT)		(*FRA)			MED	MAL		SOM
10TH	(MED)	(MAL)		(SOM)			BRA	BEL		BOS
ADDITIONAL	ENGINES: BOS, WINC, BURL			LADDERS: QUI, MED, EVE						
() Responding from Coverage Assignment. All Blank Companies above Heavy Line are per Local Runcards								Rev. Date	Issue Date	
* WESWD (WESTWOOD) Contact THRU Norfolk Cnty Control, **FRA (FRAMINGHAM), **NAT (NATICK) CONTACT THRU DIST								2/1/2024	2024-1	

WESTON

Emergency Phone

Business Phone

HEADQUARTERS STATION

394 Boston Post Rd

E1, E4, E5 (Brush), L1, R1, R2

SATION 2 Phone 781-786-6120 ext. 390

390 South Av. (Route 30)

E3, E2

METROFIRE RUNNING CARD

WESTON

MUTUAL AID BOX 8239

FIREGROUND PRIMARY CHANNEL Weston Fire Ch. FG 470.1625						ALT. FG Weston Fire Cov 472.2000			
COVERING PRIMARY CHANNEL Weston Fire Cov 472.2000						ALT. COV Metro South DISTRICT			
TO FIRE						COVER			
ALARM	ENGINES		LADDERS	SPECIAL	CHIEFS	ENGINES			LADDER
1ST						<u>STA 2</u>	<u>Headquarters</u>		
WF									
2ND									
3RD									
4TH						DED	BEL	ARL	FRA
5TH	(BEL)	(ARL)	(DED)	(FRA)		*FRA	BUR	BRK	SOM
6TH	(BUR)	(BRK)	(*FRA)	(SOM)		MIL	WINC	CAM	BRK
7TH	(WINC)	(CAM)	(MIL)	(BRK)		WOB	SOM	MED	CAM
8TH	(SOM)	(MED)	(WOB)	(CAM)		BRA	MAL	EVE	QUI
9TH	(MAL)	(EVE)	(BRA)	(QUI)		QUI	CHE	MEL	LYN
10TH	(CHE)	(MEL)	(QUI)	(LYN)		RAN	BOS	REV	MAL
ADDITIONAL	ENGINES: WAK, SAU, REA,			LADDERS: BOS, MED					
() Responding from Coverage Assignment All Blank Companies above Heavy Line are per Local Runcards							Rev. Date	Issue Date	
* FRA (Framingham), Contact Thru DISTRICT 14							2/1/2024	2024-1	

WEYMOUTH

Emergency Phone

Business Phone

STATION 1 NORTH WEYMOUTH
195 North St.

E1

STATION 2
636 Broad St.

E2, C2

STATION 3
138 Winter St. (Rear of Police Station)

E3, L2

SATION 5 SOUTH WEYMOUTH
246 Park Av.

E5

METROFIRE RUNNING CARD

WEYMOUTH

MUTUAL AID BOX 8246

FIREGROUND PRIMARY CHANNEL Weymouth Fire Ch. 1 482.0625						ALT. FG Assigned by NCC				
COVERING PRIMARY CHANNEL Assigned by Norfolk County Control						ALT. COV None				
	TO FIRE					COVER				
ALARM		ENGINES		LADDERS	SPECIAL	CHIEFS	ENGINES			LADDER
1ST							<u>E-1</u>	<u>E-5</u>		<u>L-2</u>
WF							QUI	BRA		HIN*
2ND	(QUI)	(BRA)		(HIN)*			QUI	ROC*		RAN
3RD	(QUI)	(ROC)*		(RAN)			HUL	ABI*		HOL**
4TH	NORWL*	WHI*		BRKTN	ISU & REHAB					
5TH	COH*	MIL		HAN*						
6TH	CAN**	AVO**		STOT**						
7TH	BOS	BOS		BOS		BOS D-8				
8TH	DED	NORWD**		SCI*						
9TH	BRK	NEE		CAM						
10TH	CHE	SOM		BOS						
ADDITIONAL	ENGINES: WESWD**, BOS			LADDERS: WAL, MAL, MARSH*						
() Responding from Coverage Assignment. All Blank Companies above Heavy Line are per Local Runcards										
* HIN (Hingham), ROC (Rockland), HUL (Hull), ABI (Abington), BRKTN(Brockton), HAN (Hanover), SCI (Scituate), WHI (Whitman), COH (Cohasset) Contac thru PLYMOUTH COUNTY CONTROL. --- ** HOL (Holbrook), CAN (Canton), AVO (Avon), NORWD (Norwood), STOT (Stoughton) Contact Thru NORFOLK COUNTY CONTROL										
								Rev. Date	Issue Date	
								2/1/2022	2024-1	

WINCHESTER

Emergency Phone

Business Phone

CENTRAL STATION

32 Mount Vernon St.

E1, L1, Medic 1, Medic 2

WEST SIDE STATION

45 Lockeland Rd.

E2, E4

METROFIRE RUNNING CARD

WINCHESTER

MUTUAL AID BOX 8236

FIREGROUND PRIMARY CHANNEL Winchester Fire Ch. 1 483.6875						ALT. FG Metro North FIREGROUND				
COVERING PRIMARY CHANNEL Metro North DISTRICT						ALT. COV None				
TO FIRE						COVER				
ALARM		ENGINES		LADDERS	SPECIAL	CHIEFS	ENGINES		LADDER	
1ST							<u>Headquarters</u>			
WF	WOB "RIT"									
2ND										
3RD							WAK	MEL		MAL
4TH	(WAK)	(MEL)		(MAL)			WAL	BUR		SOM
5TH	(WAL)	(BUR)		(SOM)			WAT	SOM		CAM
6TH	(WAT)	(SOM)		(CAM)			CAM	EVE		WAL
7TH	(CAM)	(EVE)		(WAL)			BOS	WIL*		EVE
8TH	(BOS)	(WIL*)		(EVE)		BOS	BRK	SAU		LYN
9TH	(BRK)	(SAU)		(LYN)			BED*	CHE		NEW
10TH	(BED)*	(CHE)		(NEW)			LINC**	WEST		BOS
ADDITIONAL ENGINES:		NEED, BRK, CAM			LADDERS:		REV, BKLE			
() Responding from Coverage Assignment. All Blank Companies above Heavy Line are per Local Runcards							Rev Date	Issue Date		
* WIL (Wilmington), BED (Bedford) Contact Thru WESTFORD CONTROL, **LINC (LINCOLN) Contact Thru District 14							2/1/2022	2024-1		

WINTHROP

Emergency Phone

Business Phone

BEACH STATION
416 Shirley St.

E1, L1

HEADQUARTERS STATION
40 Pauline St.

E2

METROFIRE RUNNING CARD

WINTHROP

MUTUAL AID BOX 8213

FIREGROUND PRIMARY CHANNEL Metro Central Fire Ground							ALT. FG Metro North Fire Ground			
COVERING PRIMARY CHANNEL Winthrop Fire Ch. 1 483.6375							ALT. COV Metro Central District			
	TO FIRE						COVER			
ALARM		ENGINES		LADDERS	SPECIAL	CHIEFS	ENGINES		LADDER	
1ST							<u>HQ</u>		<u>BEACH STATION</u>	
WF		MSPRT		REV			CHE		REV	CHE
2ND	(CHE)	(REV)		(CHE)			BOS		EVE	BOS
3RD	(BOS)	(EVE)	BOS	(BOS)		BOS	BOS		LYN	EVE
4TH	BOS	MAL	SAU	BOS						
5TH	LYN	SOM	CAM	LYN						
6TH	MEL	STON	MED	MAL						
7TH	CAM	WAK	ARL	SOM						
8TH	WOB	BRK	WINC	MED						
9TH	BEL	LEX	NEW	CAM						
10TH	BUR	WAL	WAT	BRK						
ADDITIONAL	ENGINES: WAL, NEW,					LADDERS: NEW, WAL			Rev. Date	Issue Date
() Responding from Coverage Assignment. All Blank Companies above Heavy Line are per Local Runcards								2/1/2022	2024-1	

WOBURN

Emergency Phone

Business Phone

STATION 1 SOUTH WOBURN 124 Main St. @ Hudson St.

T1 (Quint)

HEADQUARTERS STATION 731 Main Street

E2, C3, R1, R2, Special Hazards 6

STATION 4 EAST WOBURN- 36 Central St.

E4

STATION 5 WEST WOBURN- 125 Lexington St. @ Willow St.

E5

METROFIRE RUNNING CARD

WOBURN

MUTUAL AID BOX 8237

FIREGROUND PRIMARY CHANNEL Woburn Fire Ch. 1 483.6125							ALT. FG Metro North FIREGROUND			
COVERING PRIMARY CHANNEL Metro North DISTRICT							ALT. COV NONE			
TO FIRE							COVER			
ALARM		ENGINES		LADDERS	SPECIAL	CHIEFS		ENGINES		LADDER
1ST							<u>HQ</u>	<u>E-4</u>	<u>E-5</u>	<u>T-1</u>
WF	WINC "RIT"							REA	BUR	
2ND	(REA)	(BUR)		STON			WIL*	WAK	LEX	MED
3RD	(WIL*)	(LEX)	(WAK)	(MED)			NREA**	MEL	ARL	MAL
4TH	(NREA**)	(MEL)	(ARL)	(MAL)			BIL*	MED	WAL	SOM
5TH	SAU	MAL	SOM	WAL						
6TH	BEL	CAM	NEW	CAM						
7TH	CHE	EVE	LYN	REV						
8TH	BOS	WAT	WEST	BOS		BOS				
9TH	WAL	LYN	NEE	NEW						
10TH	MSPRT	REV	BOS	LYN						
ADDITIONAL ENGINES: WEL, NEW							LADDERS: WEL			
() Responding from Coverage Assignment All Blank Companies above Heavy Line are per Local Runcards								Rev Date	Issue Date	
*WIL (Wilmington) Contact Thru WESTFORD CONTROL ** NREA (North READING) Contact Thru BEVERLY CONTROL								4/26/2023	2024-1	

This Page Intentionally Left Blank

METROFIRE RUNNING CARD

Community

MUTUAL AID BOX #

FIREGROUND PRIMARY CHANNEL As assigned by Norfolk County Control						ALT. FG Assigned by NCC			
COVERING PRIMARY CHANNEL Dedham Fire Ch. 1 453.6875						ALT. COV None			
TO FIRE						COVER			
ALARM	ENGINES			LADDERS	SPECIAL	CHIEFS	ENGINES		LADDER
1ST									
WF									
2ND									
3RD									
4TH									
5TH									
6TH									
7TH									
8TH									
9TH									
10TH									
ADDITIONAL ENGINES:			LADDERS:						
() Responding from Coverage Assignment. All Blank Companies above Heavy Line are per Local Runcards									
NOTES							Rev. Date	Issue Date	

This page Intentionally Left Blank

METROFIRE SPECIAL APPARATUS

The following Special Apparatus is available by special call through Metrofire Control Center

Heavy Rescues	Lighting Plants	Towers	Foam Engines	Brush Trucks
Boston (2)	Boston	Boston-95' (3)	Boston	Boston (2)
Braintree	Massport	Burlington-95'	Burlington (2)	Belmont
Cambridge	Wellesley	Cambridge-96'	*Cambridge (2)	Braintree
Chelsea		Chelsea-95'	Chelsea	Burlington
Everett		Lynn-95'	Everett (3)	Lexington
Newton		Massport 100'	Lexington (2)	Medford
Quincy		Randolph-100'	*Massport	Milton
Somerville		Somerville	Newton	Needham
Waltham		Waltham-95'	Randolph (2)	Quincy
Woburn		Watertown	Reading	Randolph
		Wellesley-95'	Revere	Saugus
		Woburn 95'	Saugus	Weston
			Somerville (5)	Weymouth
			Stoneham (2)	
			Wakefield	
			Waltham	
			Weston	
V2024-1			Weymouth (3)	
			*Pump & Roll	

METROFIRE SPECIALIZED UNITS

<u>Metrofire Hazardous Materials Vehicles</u>		<u>Communications</u>	
DFS Truck 21 TOMS		Boston	
DFS Truck 22 ORU			
<u>MASS Decon Units</u>	<u>CD/Aux Units</u>	<u>Air Supply</u>	<u>Bulk Foam</u>
Brookline	Arlington LP & Air	Cambridge	Chelsea 500 Gal AFFF AR Foam Trailer
Boston (10)	Medford LP	Newton	Massport 750 Gal AFFF Foam Trailer
Burlington	Somerville LP & PO	Revere	Massport 750 Gal AFFF AR Foam Trailer
Cambridge (2)	Stoneham LP	Woburn & LP	Needham 500 Gal AFFF AR Foam Trailer
Everett	Waltham LP & Air		
Massport			
Medford	LP= Light Plant		
Melrose	Air= Air Supply		
Milton	PO= Pump Out		
Needham	BT=Brush Truck		
Newton			
Somerville	<u>DIVE TEAM</u>	<u>FUEL</u>	
Waltham	Stoneham Fire	Stonheam Fire	
Winchester			
V2024-1			

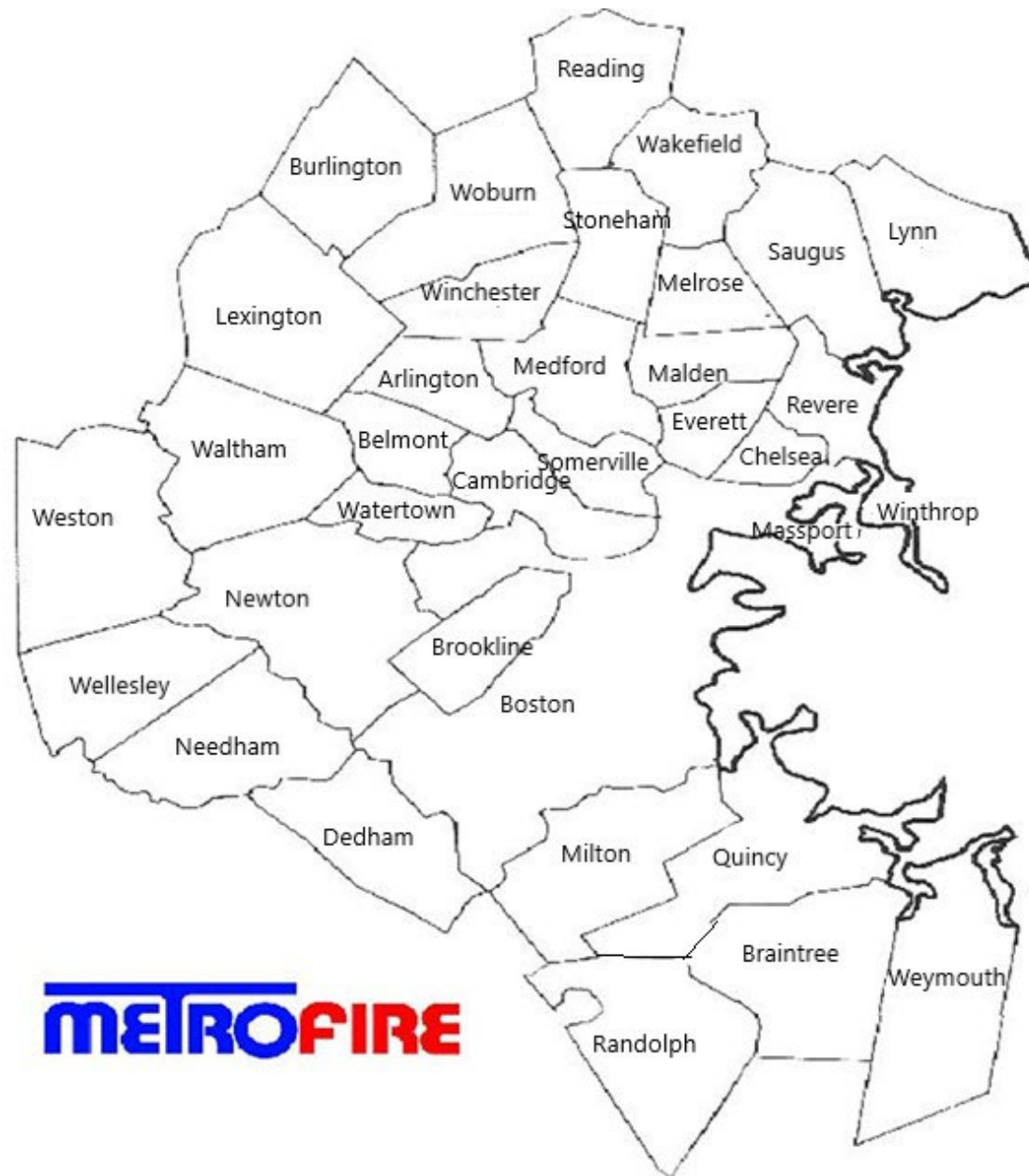

METRO FIRE

METRO FIRE MUTUAL AID SIGNAL LIST

SIGNAL	DEPARTMENT	ABBREV	SIGNAL	DEPARTMENT	ABBREV	SIGNAL	DEPARTMENT	ABBREV
8211	Massport	MSPRT	8243	Randolph	RAN	8275	Lynnfield	LYNF
8212	Boston	BOS	8244	Braintree	BRA	8276	N. Reading	NREA
8213	Winthrop	WINT	8245	Holbrook	HOL	8277	Peabody	PEA
8214	Revere	REV	8246	Weymouth	WEY	8278	Salem	SAL
8215	Chelsea	CHE	8247	Abington	ABI	8279	Nahant	NAH
8216	Everett	EVE	8248	Avon	AVO	8281	Maynard	MAY
8217	Somerville	SOM	8249	Brockton	BRKTN	8282	All Other Departments	*
8218	Cambridge	CAM	8251	Scituate	SCI	8283	Andover	AND
8219	Watertown	WAT	8252	Canton	CAN	8284	Danvers	DAN
8221	Newton	NEW	8253	Norwood	NORWD	8285	Lawrence	LAW
8222	Brookline	BRK	8254	Westwood	WESWD	8286	Lowell	LOW
8223	Dedham	DED	8255	Dover	DOV	8287	Middleton	MID
8224	Milton	MIL	8256	Lincoln	LIN	8288	N. Andover	NAND
8225	Quincy	QUI	8257	Bedford	BED	8289	Topsfield	TOP
8226	Malden	MAL	8258	Burlington	BUR	8291	Cohasset	COH
8227	Melrose	MEL	8259	Hanscom	HANSC	8292	Hull	HUL
8228	Medford	MED	8261	Natick	NAT	8293	Hingham	HIN
8229	Arlington	ARL	8262	Framingham	FRA	8294	Rockland	ROC
8231	Belmont	BEL	8263	Wayland	WAY	8295	Norwell	NORWL
8232	Waltham	WAL	8264	Sudbury	SUD	8296	Marshfield	MARSH
8233	Wakefield	WAK	8265	Concord	CON	8297	Easton	EAS
8234	Stoneham	STON	8266	Carlisle	CAR	8298	Sharon	SHA
8235	Reading	REA	8267	Billerica	BIL	8299	Foxborough	FOX
8236	Winchester	WINC	8268	Tewksbury	TEW	*	Stoughton	STOT
8237	Woburn	WOB	8269	Wilmington	WIL	*	Walpole	WALP
8238	Lexington	LEX	8271	Lynn	LYN	*	Wenham	WEN
8239	Weston	WEST	8272	Swampscott	SWA	*	Whitman	WHI
8241	Wellesley	WEL	8273	Marblehead	MAR	BOLD ARE METROFIRE DEPARTMENTS		
8242	Needham	NEE	8274	Saugus	SAU			

METROFIRE STANDARDIZED DEPARTMENT ABBREVIATIONS

ABBREV	DEPARTMENT	MA BOX	ABBREV	DEPARTMENT	MA BOX	ABBREV	DEPARTMENT	MA BOX
ABI	Abington	8247	LAW	Lawrence	8285	SAL	Salem	8278
AND	Andover	8283	LEX	Lexington	8238	SAU	Saugus	8274
ARL	Arlington	8229	LIN	Lincoln	8256	SCI	Scituate	8251
AVO	Avon	8248	LOW	Lowell	8286	SHA	Sharon	8298
BED	Bedford	8257	LYN	Lynn	8271	SOM	Somerville	8217
BEL	Belmont	8231	LYNF	Lynnfield	8275	STON	Stoneham	8234
BIL	Billerica	8267	MAL	Malden	8226	STOT	Stoughton	*
BOS	Boston	8212	MAR	Marblehead	8273	SUD	Sudbury	8264
BRA	Braintree	8244	MARSH	Marshfield	8296	SWA	Swampscott	8272
BRK	Brookline	8222	MAY	Maynard	8281	TEW	Tewksbury	8268
BRKTN	Brockton	8249	MED	Medford	8228	TOP	Topsfield	8289
BUR	Burlington	8258	MEL	Melrose	8227	WAK	Wakefield	8233
CAM	Cambridge	8218	MID	Middleton	8287	WAL	Waltham	8232
CAN	Canton	8252	MIL	Milton	8224	WALP	Walpole	*
CAR	Carlisle	8266	MSPRT	Massport	8211	WAT	Watertown	8219
CHE	Chelsea	8215	NAH	Nahant	8279	WAY	Wayland	8263
COH	Cohasset	8291	NAND	N. Andover	8288	WEL	Wellesley	8241
CON	Concord	8265	NAT	Natick	8261	WEN	Wenham	*
DAN	Danvers	8284	NEE	Needham	8242	WEST	Weston	8239
DED	Dedham	8223	NEW	Newton	8221	WESWD	Westwood	8254
DOV	Dover	8255	NORWD	Norwood	8253	WEY	Weymouth	8246
EAS	Easton	8297	NORWL	Norwell	8295	WHI	Whitman	*
EVE	Everett	8216	NREA	N. Reading	8276	WIL	Wilmington	8269
FOX	Foxborough	8299	PEA	Peabody	8277	WINC	Winchester	8236
FRA	Framingham	8262	QUI	Quincy	8225	WINT	Winthrop	8213
HANSC	Hanscom	8259	RAN	Randolph	8243	WOB	Woburn	8237
HIN	Hingham	8293	REA	Reading	8235	*	All other Departments	8282
HOL	Holbrook	8245	REV	Revere	8214	BOLD ARE METROFIRE DEPARTMENTS		
HUL	Hull	8292	ROC	Rockland	8294			

METROFIRE DEPARTMENT RADIO CHANNELS FOR FIREGROUND AND COVERING 2024

Department	Primary Fireground Channel	Alternate Fireground Channel	Primary Covering Channel	Alternate Covering Channel
Arlington	Arlington Fire Ch. 1	Metro North FIREGROUND	Metro North DISTRICT	None
Belmont	Belmont Fire Ch. 1	Belmont Fire Ch. 3	Belmont Fire Ch. 3	Metro North DISTRICT
Boston	Assigned by Boston FA	As Assigned	Boston Fire Ch. 1	As Assigned by Boston FA
Braintree	Braintree Fire Ch. 1	Assigned by Norfolk CC	Assigned by Norfolk CC	None
Brookline	Brookline Fire Ch. 1	Metro Central FIREGROUND	Metro Central DISTRICT	None
Burlington	Burlington Fire Ch. 1	Metro North FIREGROUND	Metro North DISTRICT	None
Cambridge	Assigned by Cambridge FA	Assigned by Cambridge FA	Cambridge Fire Ch. 1	None
Chelsea	Chelsea Fire Ch. 2	Chelsea Fire Ch. 3	Chelsea Fire Ch. 1	None
Dedham	Assigned by Norfolk CC	Assigned by Norfolk CC	Dedham Fire Ch. 1	None
Everett	Metro Central FIREGROUND	Metro North FIREGROUND@	Everett Fire Ch. 1	None
Lexington	Lexington Fire Ch. 1	Metro North FIREGROUND	Metro North DISTRICT	None
Lynn	Lynn Fire Ch. 2	Metro North FIREGROUND	Lynn Fire Ch. 1	None
Malden	Metro North FIREGROUND	Metro Central FIREGROUND	Malden Fire Ch. 1	None
Massport Hanscom	Metro North DISTRICT	See ICS205	See ICS205	None
Massport Logan	Massport Fire Ch. 1	Metro Central FIREGROUND	None	None
Medford	Metro North FIREGROUND	Metro Central FIREGROUND	Medford Fire Ch. 1	None
Melrose	Metro North FIREGROUND	Metro Central FIREGROUND	Melrose Fire Ch. 1	None
Milton	Assigned by Norfolk CC	Assigned by Norfolk CC	Milton Fire Ch. 1	None
Needham	Needham Fire Ch. 1	Metro South FIREGROUND	Metro South DISTRICT	None
Newton	Newton Fire Ch. 1	Newton Fire Ch. 2	Newton Fire Ch. 2	Metro North DISTRICT
Quincy	Quincy Fire Ch. 2	Quincy Fire Ch. 3	Quincy Fire Ch. 1	None
Randolph	Assigned by Norfolk CC	Assigned by Norfolk CC	Randolph Fire Ch. 1	None
Reading	Reading Fire Ch. 1	Metro North FIREGROUND	Metro North DISTRICT	None
Revere	Metro Central FIREGROUND	Metro North FIREGROUND	Revere Fire Ch. 1	None
Saugus	Metro North FIREGROUND	Metro South FIREGROUND	Saugus Fire Ch. 1	None
Somerville	Somerville Fire Ch. 2	Metro Central FIREGROUND	Somerville Fire Ch. 1	None
Stoneham	Metro North FIREGROUND	Metro South FIREGROUND	Stoneham Fire Ch. 1	None
Wakefield	Wakefield Fire Ch. 1	Metro North FIREGROUND	Metro North DISTRICT	None
Waltham	Waltham Fire Ch. 2	Waltham Fire Ch. 1	Waltham Fire Ch. 1	Metro North DISTRICT
Watertown	Watertown Fire FIREGROUND	Watertown Fire DISPATCH	Watertown Fire DISPATCH	Metro North DISTRICT
Wellesley	Wellesley Fire Ch. 1	Metro South FIREGROUND@	Metro South DISTRICT	None
Weston	Weston Fire Ground	Weston Coverage	Weston Coverage	Metro South DISTRICT
Weymouth	Weymouth Fire Ch. 1	Assigned by Norfolk CC	Assigned by Norfolk CC	None
Winchester	Winchester Fire Ch. 1	Metro North FIREGROUND	Metro North DISTRICT	None
Winthrop	Metro Central FIREGROUND	Metro North FIREGROUND	Winthrop Fire Ch. 1	Metro Central DISTRICT
Woburn	Woburn Fire Ch. 1	Metro North FIREGROUND	Metro North DISTRICT	None
V2024				

MASSPORT LOGAN

STAGING AREA & MAPS

Primary Staging

MASSPORT LOGAN NORTH GATE STAGING 200 Prescott St. East Boston

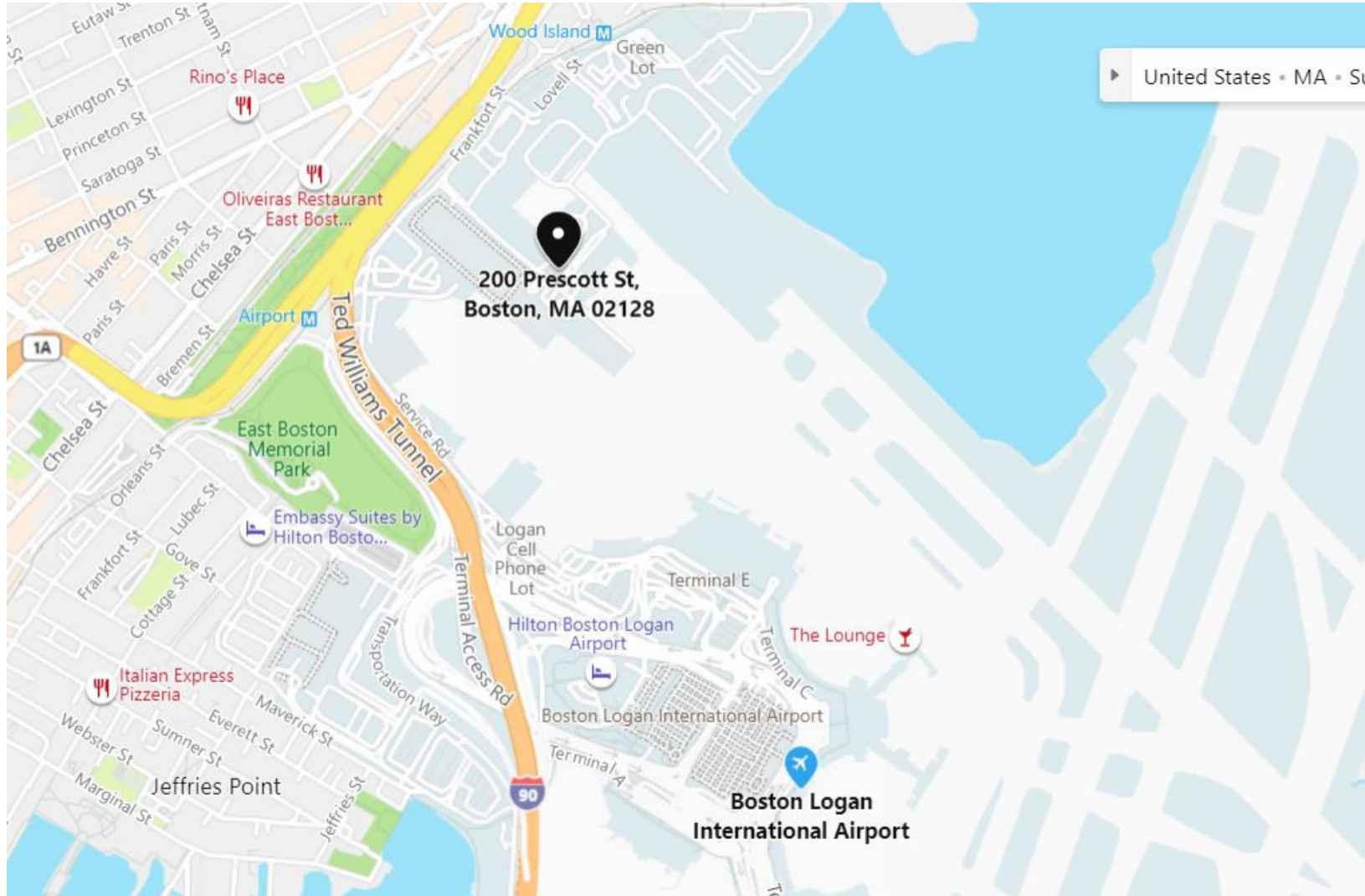

MASSPORT LOGAN NORTH STAGING DETAIL

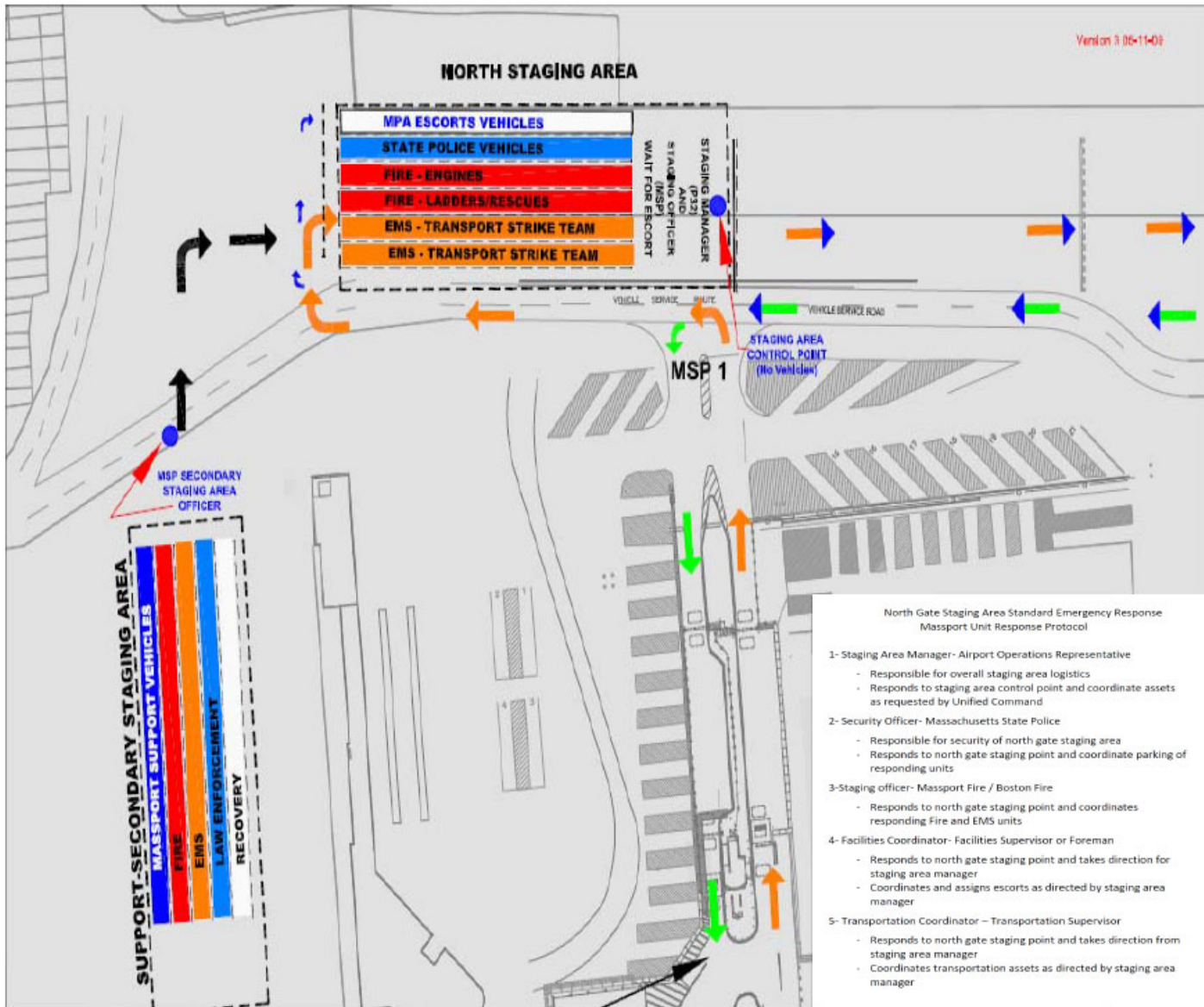

MASSPORT LOGAN SOUTH GATE STAGING 158 Harborside Dr. East Boston.

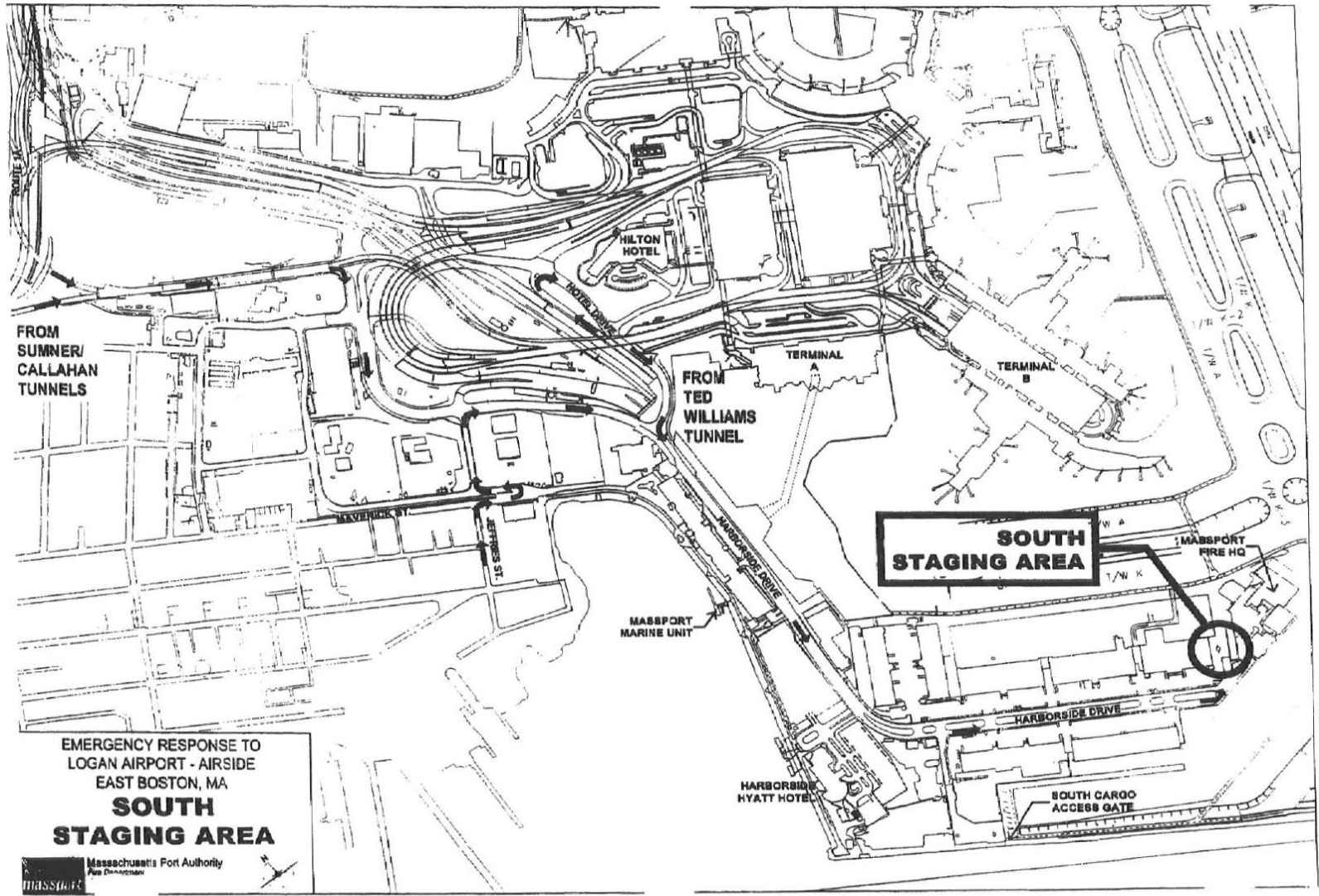

Tomahawk Staging 40 Tomahawk Dr. East Boston

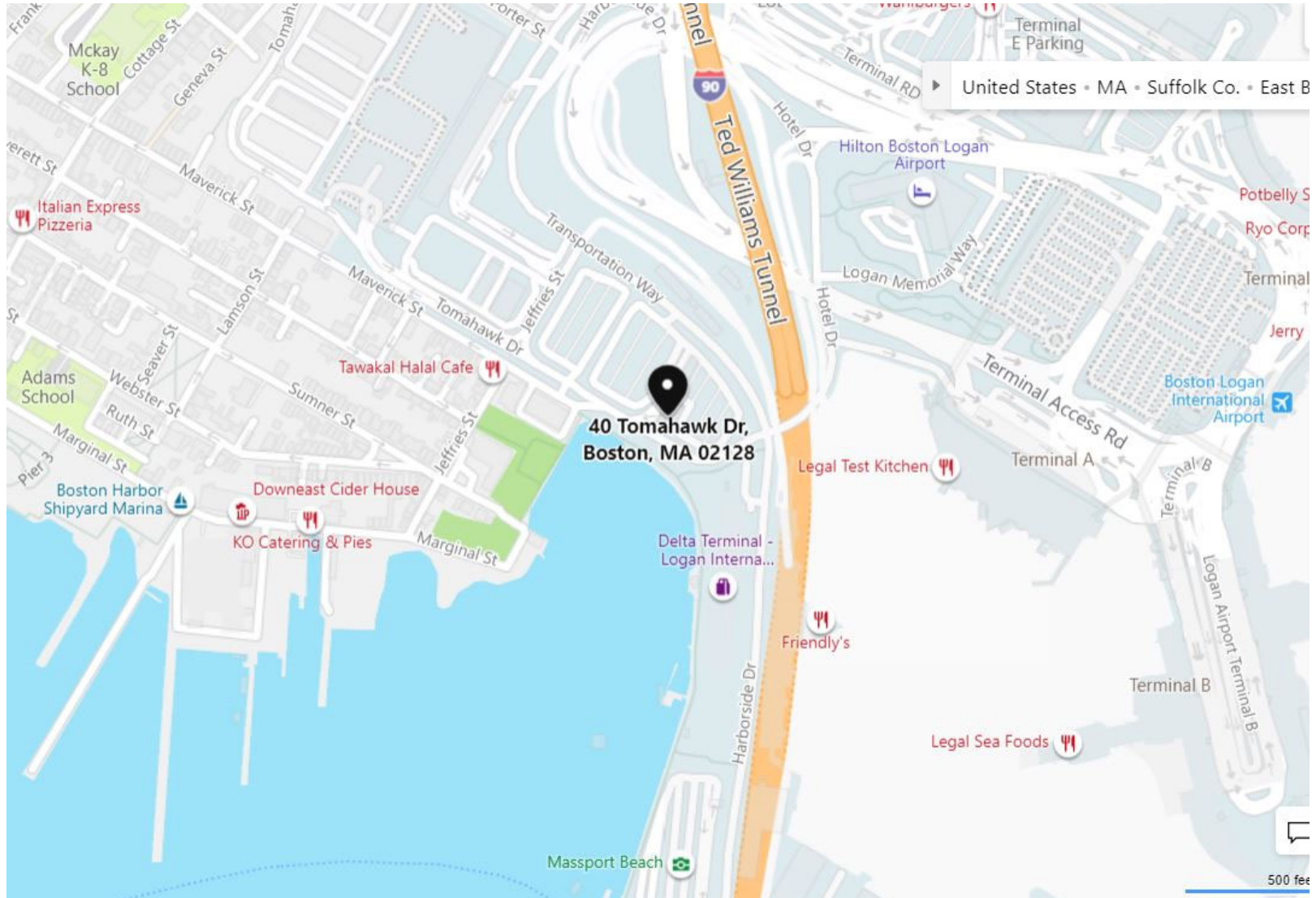

This Page Intentionally Left Blank

MBHSR Technical Response Definitions

This Response Plan is for a “MAJOR” Incident like a building collapse, or any incident that vastly overwhelms the capabilities of the local response and or mutual aid assistance.

“LOCAL” response does not denote a response within the MBHSR; but refers to a response that requires less resources, but very specific resources to mitigate. For example: rope rescue, confined space, trench, or minor water rescue. These are response that most departments are capable of mitigating alone, but may lack the capability to do so. With the exception of Boston, and additional rescue company from the nearest city or town should also be dispatched as a support company to the primary jurisdiction.

WATER RESCUES

“LOCAL” water rescue differs from the establishment of a “Water Rescue Strike Team or Task Force” for deployment within the region or State, in response to or anticipation of a storm surge/flooding type event. This response would utilize more responders, and would be deployed as a team, rather than a single resource for a singular person in the water, or a “Localized” incident.

“MAJOR” water incident would mor likely be a “Planned” event so would probably be a “pre-staged” even that would allow units to assemble at a determined point, rally and then deploy as a group.

MBHSR Technical Response North Metro Response

Communities: Cambridge, Chelsea, Everett, Revere, Somerville, Winthrop

LEVEL 1 (Minor): Local Response protocol

LEVEL 2 (Major): **BOSTON Fire**

UASI TRLR-1 (transport by Engine 10), Collapse Rescue 1, Rescue 1, H6, Safety Chief H1, Engine 28, Tower Ladder 3, Division 1 (Liaison), District 6 (Staging – Rescue Ops)

CAMBRIDGE Fire

USAI TRLR-2 (transport by Ladder 1), Cambridge Deputy Chief (Task Force Leader), Engine 1, Rescue 1, Squad (UASI Trained Medics)

SOMERVILLE Fire

Rescue 1, Tower Ladder, District Chief,

OTHER Fire:

Chelsea Rescue, Everett Rescue, Revere 1 Firefighter, Winthrop 1 Firefighter

Boston Emergency Medical Services (BEMS):

BLS Unit, ALS Unit (UASI Trained Medics), Special Ops Vehicle,

****When Requesting MBHSR Urban Search and Rescue (US&R) resources the following information should be supplied:**

- | | |
|---|--|
| -Type and nature of incident | -Confirmed injuries or people entrapped or missing |
| -Location of Command Post & Incident Commander | -Location of Staging / Assembly area |
| -Approximate Size of Staging / Assembly area | -Point of Contact at Staging / Assembly Area |
| -Radio Operations channel local community & Tactical Incident | |

MBHSR Technical Response South Metro Response

Communities: Boston, Brookline, Quincy

LEVEL 1 (Minor): Local Response protocol

LEVEL 2 (Major): **BOSTON Fire**

UASI TRLR-1 (transport by Engine 10), Collapse Rescue 1, Rescue 2, H6, Safety Chief H1, Engine 28, Engine 42, Tower Ladder 10, Division 2 (Liaison), District 9 (Rescue Ops)

CAMBRIDGE Fire

USAI TRLR-2 (transport Rescue 1), Cambridge Deputy Chief (Staging -Task Force Leader), Rescue 1, Squad (UASI Trained Medics)

OTHER Fire:

Brookline 1 Firefighter, Quincy 2 Firefighters

Boston Emergency Medical Services (BEMS):

BLS Unit, ALS Unit (UASI Trained Medics), Special Ops Vehicle,

****When Requesting MBHSR Urban Search and Rescue (US&R) resources the following information should be supplied:**

- | | |
|---|--|
| -Type and nature of incident | -Confirmed injuries or people entrapped or missing |
| -Location of Command Post & Incident Commander | -Location of Staging / Assembly area |
| -Approximate Size of Staging / Assembly area | -Point of Contact at Staging / Assembly Area |
| -Radio Operations channel local community & Tactical Incident | |

METROFIRE MBHSR HAZMAT OR WEAPON OF MASS DESTRUCTION RESPONSE

Boston resources respond to Chelsea, Revere, Quincy, and Winthrop

Cambridge resources respond to Brookline, Everett, and Somerville

HAMAT LEVEL

LEVEL "0": Local city or town response protocols

Reconnaissance Consultation:
BOSTON FIRE: Hazmat Specialist
CAMBRIDGE FIRE: Rescue as determined by Cambridge Fire Department.
BOSTON POLICE: Notify Boston Police Hazmat Response Unit (HRU)

LEVEL 1
BOSTON FIRE: Hazmat Engine, Hazmat Ladder, Hazmat Chief, Hazmat Specialist, (Hazmat Unit & HAMR Unit available upon request)
CAMBRIDGE FIRE: To be determined based on information from requesting community
****** :BFD Hazmat Specialist & HAMR Unit respond with both BFD and CFD Fire Resources
BOSTON POLICE: Notify Hazmat Response Unit (HMRU)

LEVEL 2 or 3
BOSTON FIRE: Hazmat Engine, Hazmat Ladder, Hazmat Chief, Hazmat Unit, HAMR Unit, Hazmat Specialist
CAMBRIDGE FIRE: To be determined based on information from requesting community
BOSTON EMS: Paramedic Unit, Supervisor (Responder monitoring, Safety & Rehab)
BOSTON POLICE: Hazmat Response Unit (HMRU)
BOSTON OTHER: Notify Boston Public Health Commission (BPHC) for potential response of an Environmental Health and Specialist.

****If incident involves EXPLOSIVES request Boston or Cambridge Police Department EOD Units.**

When requesting MBHSR Hazmat Resources, the following information shall be requested and provided.

- Type and nature of incident
- Location of Command Post & Incident Commander
- Approximate Size of Staging / Assembly area
- Radio Operations channel local community & Tactical Incident
- Confirmed injuries or people entrapped or missing
- Location of Staging / Assembly area
- Point of Contact at Staging / Assembly Area

This Page Intentionally Left Blank